



Official Website

***Taizhou Xingnuo Technology Co.,Ltd.***

🏠 Address: Qinggang Industrial Zone ,Yuhuan City,Zhejiang Province,China.

☎ Tel: +86-0576-87104728

📠 Fax: +86-0576-87104728

✉ E-mail: [trading@cnxingnuo.com](mailto:trading@cnxingnuo.com) [sales@cnxingnuo.com](mailto:sales@cnxingnuo.com) [wurende@cnxingnuo.com](mailto:wurende@cnxingnuo.com)

🌐 Website: [www.cnxingnuo.com](http://www.cnxingnuo.com)





## About Us



Taizhou Xingnuo Technology Co., Ltd. was founded in 1989. With a fixed asset of RMB 10.8 million and an area of 13000 square meters, the company has been engaged in the development and production of brass, lead-free copper, and DZR since its establishment. the company has accumulated rich production experience and created a group of professional technicians have established a complete set of product quality assurance system. The company has become a professional manufacturer integrating design, development, production and sales.

The main production of valve series, pipe fittings series, heating radiator series, HVAC, etc. More than a thousand varieties, material to red dust, casting-based

The company has more than 80 CNC lathes, 8 multi-station machine tools, 2 special planes, 2 machining centers and other professional development and production equipment in casting finishing.

Xingnuo Company regards product quality as the life of the enterprise, conscientiously implements the quality policy of "pragmatic, precision manufacturing, continuous improvement, and customer satisfaction", and uses modern quality management methods and standardized testing procedures to make Benefit products become partners and reliable quality. Xingnuo, has design studios, laboratory centers, and testing centers. The products are exported to many countries, including Russia, United States, Germany, Australia, Canada, and Taiwan... Regional and long-term cooperation with many dealers. We are your reliable business partner.





## Sophisticated Production Equipments

In order to meet domestic and international demands, we have implemented automated and standardized production process in our workshop by introducing world-class production line. Meanwhile, our insisting belief on the principle “Quality is the Life of the Enterprise”, constant improvement of test methods, establishment of high-level supervision and inspection institution and advanced production technology and equipment make sure our quality steady and consistent.





# 7 Big Advantage

Raw material procurement all through the German spectral analysis together with laboratory tests, to ensure that the material to achieve kinds of requiements and other standards.

Product surface after special treatment, so that their products in the use of the process is not easy to change.

Using intelligent testing equipment, the product is not inspection and testing, so that the product life is longer.

After sales service: we uphold the quality of this, integrity first, customer first philosophy, and serve you wholeheartedly.

Precision machining using imported mechanical processing, dimensional accuracy is high, so that the product seal better and more durable.

Parts of the purchase, all through strict examination, selection of fully qualified suppliers.

The use of professional mechanical hand assembly, the product surface is more beautiful, internal parts are not damaged.

## CHINA QUALITY SERVICES WORLDWIDE

## We Focusing on Partner

To provide most competitive branded products is our ultimate target.

We keep introducing market-oriented and clients-oriented brand concepts to achieve this object.

From the design to after-sales service, we have paid massive attention to enable our branded products to meet market requirements.





The comparison list of copper rod standard

Corporation Standard												Overseas Standard											
Models		Element value%										Models		Element value%									
		Cu	Pb	Al	Fe	Mn	C	Su	As	Zn	Other Impurity			Cu	Pb	Al	Fe	Mn	C	Su	As	Zn	Impurity
58-3A	57-60	2.0-3.0	0.5	0.5						Rest	2.0	Japan C3603	57-61	1.8-3.7			0.35					Rest	Fe+Su ≤0.6
Hpb59-1 (Dou ble A)	57-60	0.8-1.9	0.2	0.5						Rest	1.0	Japan C3604	57-61	1.8-3.7			0.5					Rest	Fe+Su ≤1.2
												Japan C3605	56-60	3.5-4.5			0.5					Rest	Fe+Su ≤1.2
												America C37700	58-61	1.5-2.5			0.3					Rest	0.5
												America C37710	56-560	1.0-3.0			0.3					Rest	0.5
												Europe CW614N	57-59	2.5-3.5			0.3					Rest	0.2
												Europe CW617N	57-59	1.6-2.5			0.3					Rest	0.2
59-1A	57-60	0.8-1.9								Rest	1.0												
59-2A	57-59	1.5-2.5								Rest	1.0												
59-1B	57-60	0.8-2.5								Rest	2.0												
60-3	60-61	2.0-3.0								Rest	2.0												
60-1A	60-63	0.8-1.2								Rest	1.0	America C37100	58-62	0.6-1.2			0.15					Rest	0.4
												America C37000	59-62	0.8-1.5			0.15					Rest	0.4
60-2A	60-63	2.5-3.7	0.3	0.3								America C36000	60-63	2.5-3.7			0.35					Rest	0.5
AsA	60-63	1.7-2.8	0.05							Rest	0.5	Europe CW602N	61-63	1.7-2.8	0.05	0.1	0.1	0.3	0.3	0.1	0.02-0.15	Rest	0.2
												Europe CZ132	61-63	1.7-2.8	0.05	0.3				0.2	0.08-0.15		
												Europe CZ352	61-63	1.0-2.5	0.1	0.2	0.05	0.2	0.2	0.4	0.15-0.28		
												Europe C48600	59-62	1.0-2.5	0.1	0.2	0.05	0.2	0.3-1.5	0.12-0.25			
AsB	60-63	1.7-2.8	0.5	0.5						Rest	2.2	America ASTM B554-91a C84400	78-82	6.8-8.0	0.005	0.4				2.3-3.5		7-10	

Low middle pressure ball valve inspecting and testing

Methods & Procedures for shell test

Covering the entrance and exit of the valve , pressing the gland tightly to make the disc be in intermediate positions . Full filling with medium in the shell body to reach testing pressure gradually.Inspecting for the shell including the gland and union between the body and cap to see if there is leakage when reaches to stipulated time. Testing temperature.Testing medium.Testing pressure. The shortest continued time and allowed leak rate on shell test and seal function test as following sheet.

Methods & Procedures for Seal function test

Covering the two ends of the valve to make the disc be slight opening position and to reach to testing pressure with full medium in the shell body . Releasing the pressure of one end when closing.Doing the same with another end.Being tested by seal function to make sure without any leakage before selling into the markets . Testing temperature.Testing medium.Testing pressure.The shortest continued time and allowed leak rate on shell test and seal function test as following sheet.

Item	Enforce standard(AP1598)		Allowed leak rate
Shell test	Testing pressure(Mpa)	2.4	No leak (no obvious dropping of surface wet)
	Continued time(S)	15	
	Testing temperature	≤125 °F ( 52℃ )	
	Testing medium	Water	
Seal function test	Testing pressure(Mpa)	2.4	No leak (no obvious dropping of surface wet)
	Continued time(S)	15	
	Testing temperature	≤125 °F ( 52℃ )	
	Testing mediu	Water	



08	Brass Manifold
11	Brass Ball Valve
28	Brass Gas Ball Valve
36	Brass Angle Valve
39	Brass Check Valve
41	Brass Gate Valve
42	Brass Filter Valve

46	Brass Bibcock
47	Brass Exhaust Valve
48	Brass Compression Fitting
52	PEX Sliding Axial Press Fitting
55	Brass PEX-Al-PEX Fitting
59	Brass Fitting
66	Brass Inserts

MF0001-25 | Distribution Manifold

Specification

Forged brass body  
Sand blast and nickel plated  
Nominal Pressure: Max. 16bar  
Temperature: -10°C ~ 110°C  
Threaded ISO228/1  
100% leak tested  
Pipeline: 2 - 10 way

Dimensions

SIZE	A	B	C	D	E	F	G
1"	60	50	40	35	215	1216	1"
1"	60	50	40	35	215	1620	1"

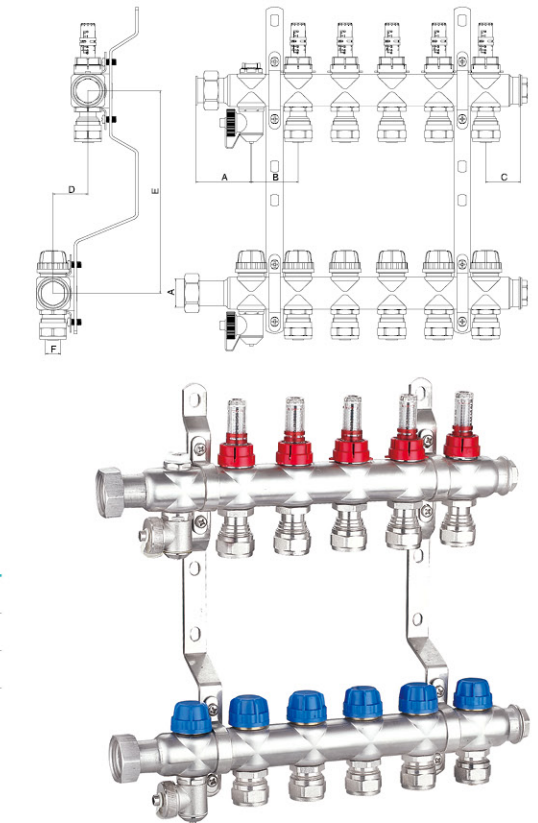

MF0002-25 | Distribution Manifold

Specification

Forged brass body  
Sand blast and nickel plated  
Nominal Pressure: Max. 16bar  
Temperature: -10°C ~ 110°C  
Threaded ISO228/1  
100% leak tested  
Pipeline: 2 - 10 way

Dimensions

SIZE	A	B	C	D	E	F	G
1"	37.5	50	37.5	35	210~215	1216	1"
1"	37.5	50	37.5	35	210~215	1620	1"

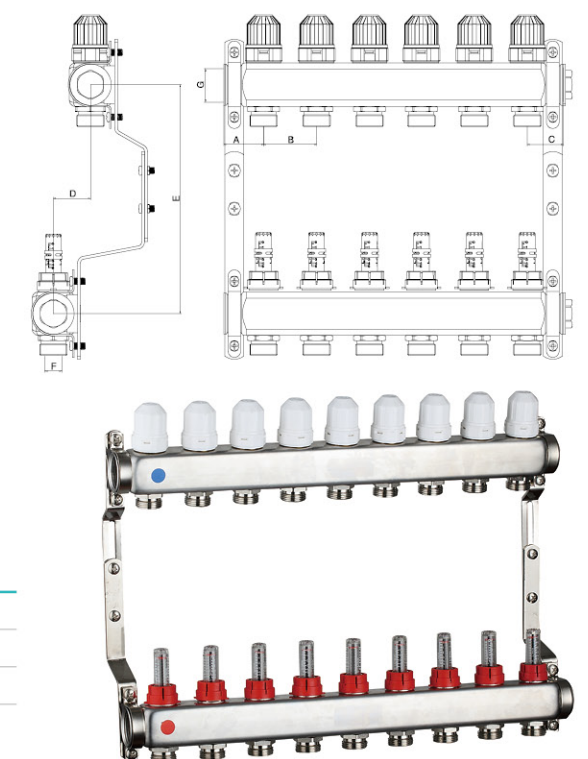



MF1002-25 | Distribution Manifold

Specification

Forged brass body  
Sand blast and nickel plated  
Nominal Pressure: Max. 16bar  
Temperature: -10℃ ~ 110℃  
Threaded ISO228/1  
100% leak tested  
Pipeline: 1 - 8 way

Dimensions

SIZE	A	B	C	D	E	F	G
1"	35	45	35	37	216	S4	1"
1"	35	45	35	37	216	S5	1"

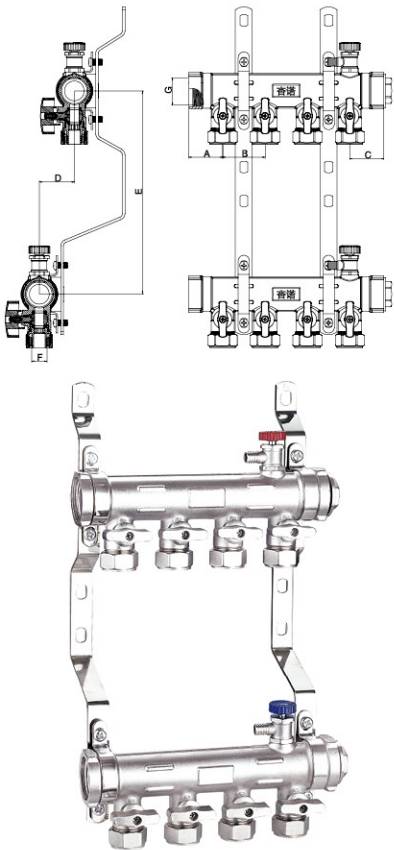

MF1601 | Manifold

Specification

Forged brass body  
Sand blast and nickel plated  
Nominal Pressure: Max. 16bar  
Temperature: -10℃ ~ 110℃  
Threaded ISO228/1  
100% leak tested  
Available: 3/4"×Ø16

Dimensions

SIZE	A	B	C	D	E	F	G
3/4"x16 - 2	86	36	37	33	Φ16	25	3/4"
3/4"x16 - 3	122	36	37	33	Φ16	25	3/4"
3/4"x16 - 4	158	36	37	33	Φ16	25	3/4"
3/4"x16 - 5	194	36	37	33	Φ16	25	3/4"

Packaging

SIZE	Weight(g)	Inner Box(mm)	Carton(mm)	Qty per inner box	Qty per carton
3/4"x16 - 2	425	22x16.5x12	34x22.5x25	12	48
3/4"x16 - 3	600	22x16.5x12	34x22.5x25	10	40
3/4"x16 - 4	753	22x16.5x12	34x22.5x25	8	32
3/4"x16 - 5	970	22x16.5x12	34x22.5x25	6	24

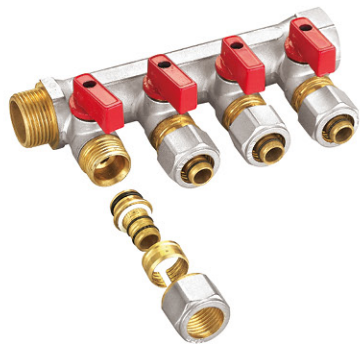
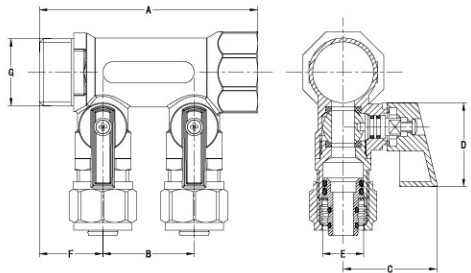

MF1501 | Manifold

Specification

Forged brass body  
Sand blast  
Nominal Pressure:Max. 16bar  
Temperature: -10℃ ~ 110℃  
Threaded ISO228/1  
100% leak tested  
Available: in all sizes from 1/2"×3/4" up to 1/2"×1"

Dimensions

SIZE	A	B	C	D	F	G	G1
3/4"×1/2"	152	50	34	24	26	3/4"	1/2"
1"×1/2"	154	50	41.5	25	27	1"	1/2"

Packaging

SIZE	Weight(g)	Inner Box(mm)	Carton(mm)	Qty per inner box	Qty per carton
3/4"x1/2" - 2	485	11x15x8	31x17x12	10	40
3/4"x1/2" - 3	650	16x15x8	31x17x17	10	40
3/4"x1/2" - 4	815	21x12x8	33x25x21	4	32
1"x1/2" - 2	590	21x11x9	23x21x19	10	40
1"x1/2" - 3	785	16x9x9	35x19x17	4	32
1"x1/2" - 4	980	21x9x9	28x22x19	4	24

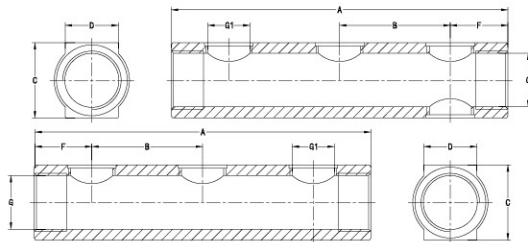

MF1602 | Manifold

Specification

Forged brass body  
Sand blast and nickel plated  
Nominal Pressure: Max. 16bar  
Temperature: -10℃ ~ 110℃  
Threaded ISO228/1  
100% leak tested  
Available:in all sizes from 3/4"×Ø16

Dimensions

SIZE	A	B	C	D	E	F	G
3/4"x16 - 2	93	36	47.5	27	Φ16	32	3/4"
3/4"x16 - 3	129	36	47.5	27	Φ16	32	3/4"
3/4"x16 - 4	165	36	47.5	27	Φ16	32	3/4"

Packaging

SIZE	Weight(g)	Inner Box(mm)	Carton(mm)	Qty per inner box	Qty per carton
3/4"x16 - 2	410	31x10x8	41x32x21	5	50
3/4"x16 - 3	590	31x14x8	33x32x29	5	40
3/4"x16 - 4	760	31x17x8	35x32x17	5	20

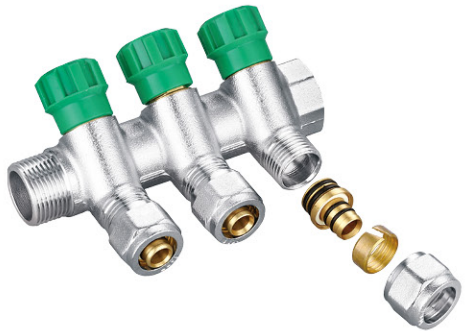
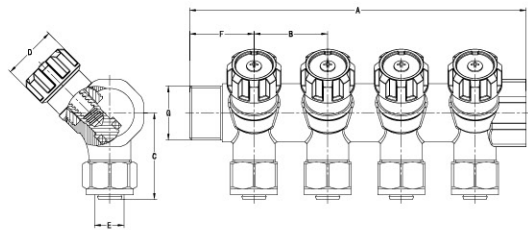





BV1022 | Brass Ball Valve

Specification

Forged brass body  
Sand blast and nickel plated  
Nominal Pressure: Max. 25bar  
Temperature: -10~110°C  
Threaded F/F ISO228/1  
100% leak tested

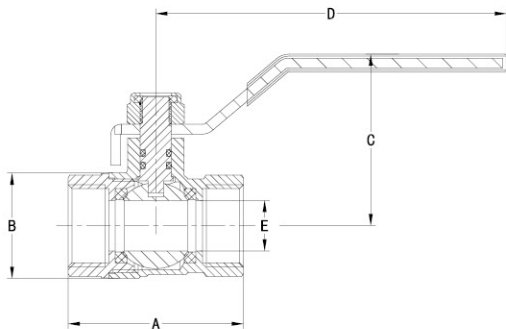

Dimensions

SIZE	A	B	C	D	E
1/4"	39	22	35	80	10
3/8"	39	22	35	80	10
1/2"	45	27	44	90	13
3/4"	51.5	34	47.5	100	18
1"	59.5	41.3	53	128	22.5
1 1/4"	71	50	65	134.5	29
1 1/2"	80	60	74.5	165.5	34
2"	95.5	77.5	82	165.5	45
2 1/2"	120	100.5	122	240	60
3"	141.5	120	130.5	240	73
4"	172.5	146.5	143.5	240	90

Packaging

SIZE	Weight(g)	Inner Box(mm)	Carton(mm)	Qty per inner box	Qty per carton
1/4"	93	14.5x14.5x6	32x16x30.5	18	180
3/8"	88	14.5x14.5x6	32x16x30.5	18	180
1/2"	154	21.5x13.5x7.5	39x23x28.5	12	120
3/4"	211	21.5x13.5x7.5	39x23x28.5	12	120
1"	347	16.5x13x8	42x18x27.5	6	60
1 1/4"	500	22.5x12.5x8	42x24x26.5	4	40
1 1/2"	770	21.5x11x6.5	34x23x35	2	30
2"	1250	22.5x12.5x8	41.5x24x26.5	2	20
2 1/2"	2450	31.5x18.5x10.5	39x23x33.5	2	8
3"	3669	34x20x13	41x22x36	2	6
4"	5580	36x22.5x15.5	38x24.5x33	2	4



BV1024 | Brass Ball Valve

Specification

Forged brass body  
Sand blast and nickel plated  
Nominal Pressure: Max. 25bar  
Temperature: -10~110°C  
Threaded F/F ISO228/1  
100% leak tested

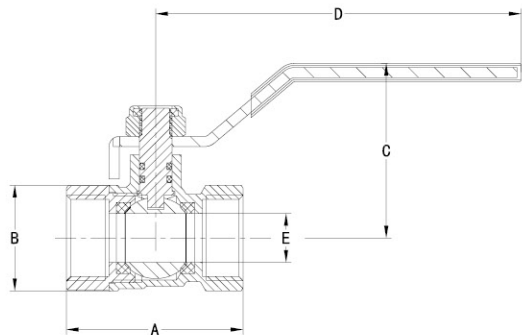

Dimensions

SIZE	A	B	C	D	E
1/2"	43.5	26	43	90	12
3/4"	50	31.5	45.5	100	15
1"	58	38.5	51	128	20
1 1/4"	68	48.5	62.5	134.5	25
1 1/2"	77	55	72.5	165.5	32
2"	91	68.5	78.5	165.5	40
2 1/2"	108	85.8	114	240	49
3"	129	100.5	122	240	60
4"	143	127.5	130.5	240	71

Packaging

SIZE	Weight(g)	Inner Box(mm)	Carton(mm)	Qty per inner box	Qty per carton
1/2"	140	14x11.5x6	33.5x16.5x26	10	100
3/4"	200	16x13x8	41.5x32.5x27	10	100
1"	311	16.5x13x8	42.5x18x28.5	6	60
1 1/4"	310	22.5x12.5x8	42.5x25x27.5	4	40
1 1/2"	683	21.5x11x6.5	35x24x36	2	30
2"	1055	22.5x12.5x8	42.5x25x27.5	2	20
2 1/2"	1990	31.5x18.5x10.5	39.5x23.5x34	2	8
3"	2781	34x20x13	41.5x22x35.5	2	6
4"	4230	36x22.5x15.5	38x24x33.5	2	4

BV1026-FF | Brass Gas Ball Valve

Specification

Forged brass body  
Sand blast and nickel plated  
Nominal Pressure: Max. 25bar  
Temperature: -10~110°C  
Threaded F/F ISO228/1  
100% leak tested

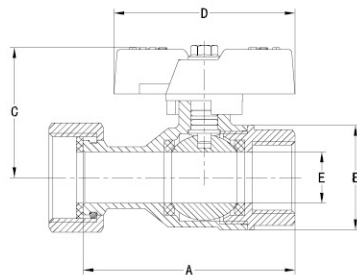

Dimensions

SIZE	A	B	C	D	E
1/2"x3/4"	62	30.5	38	53	15
3/4"x3/4"	67	33.5	39.5	53	17

Packaging

SIZE	Weight(g)	Inner Box(mm)	Carton(mm)	Qty per inner box	Qty per carton
1/2"x3/4"	210	17.5x13.5x6	31x28x18.5	10	100
3/4"x3/4"	233	17.5x17x17	35x29x18.5	8	80



BV1026-MF | Brass Gas Ball Valve

Specification

Forged brass body  
Sand blast and nickel plated  
Nominal Pressure: Max. 25bar  
Temperature: -10~110°C  
Threaded M/F ISO228/1  
100% leak tested

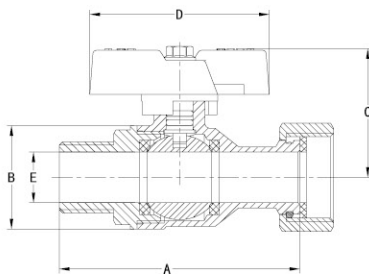

Dimensions

SIZE	A	B	C	D	E
1/2"x3/4"	71.5	30.5	38	53	15
3/4"x3/4"	79.5	33.5	39.5	53	17

Packaging

SIZE	Weight(g)	Inner Box(mm)	Carton(mm)	Qty per inner box	Qty per carton
1/2"x3/4"	220	17.5x13.5x6	31x28x18.5	10	100
3/4"x3/4"	260	17.5x17x17	35x29x18.5	10	80

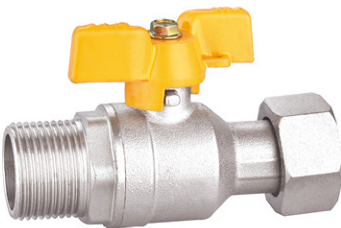



BV1027-FF | Brass Gas Ball Valve

Specification

Forged brass body  
Sand blast and nickel plated  
Nominal Pressure: Max. 25bar  
Temperature: -10~110°C  
Threaded F/F ISO228/1  
100% leak tested

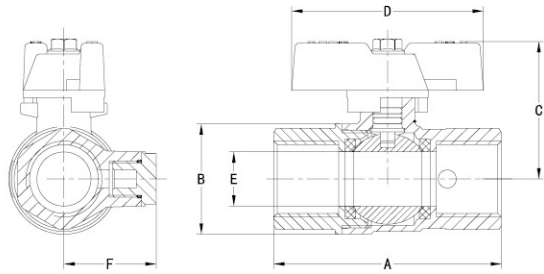

Dimensions

SIZE	A	B	C	D	E	F
1/2"	60	30.5	38	53	15	25
3/4"	66	35.5	40.5	53	19	28
1"	76	43	50	63	24	31

Packaging

SIZE	Weight(g)	Inner Box(mm)	Carton(mm)	Qty per inner box	Qty per carton
1/2"	210	22x15x6	31x25x23	10	80
3/4"	265	25x15x6.5	31x27x26	10	80
1"	436	23x10x8.5	43.5x24x21	4	40



BV1028-MF | Brass Gas Ball Valve

Specification

Forged brass body  
Sand blast and nickel plated  
Nominal Pressure: Max. 25bar  
Temperature: -10~110°C  
Threaded M/F ISO228/1  
100% leak tested

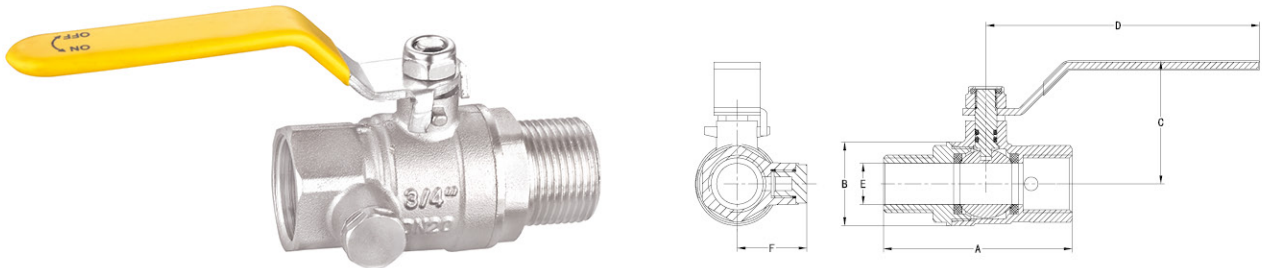

Dimensions

SIZE	A	B	C	D	E	F
1/2"	66	30.5	45	100	15	25
3/4"	73	35.5	47.5	100	19	28
1"	82	43	56.5	128	24	31

Packaging

SIZE	Weight(g)	Inner Box(mm)	Carton(mm)	Qty per inner box	Qty per carton
1/2"	239	29x16x9	37x33x30	10	80
3/4"	309	29x18x8	37x30x25	5	30
1"	482	29x18x8	37x30x25	5	30



BV1027-MF | Brass Gas Ball Valve

Specification

Forged brass body  
Sand blast and nickel plated  
Nominal Pressure: Max. 25bar  
Temperature: -10~110°C  
Threaded M/F ISO228/1  
100% leak tested

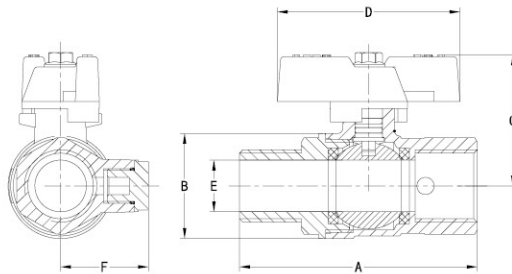

Dimensions

SIZE	A	B	C	D	E	F
1/2"	66	30.5	38	53	15	25
3/4"	73	35.5	40.5	53	19	28
1"	82	43	50	63	24	31

Packaging

SIZE	Weight(g)	Inner Box(mm)	Carton(mm)	Qty per inner box	Qty per carton
1/2"	213	22x15x6	31x25x23	10	80
3/4"	283	23x10x8.5	43.5x24x21	4	40
1"	443	23x10x8.5	43.5x24x21	4	40

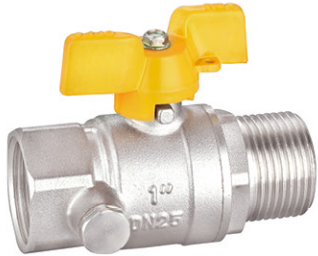



BV1030-FF | Brass Lock Valve

Specification

Forged brass body  
Sand blast and nickel plated  
Nominal Pressure: Max. 25bar  
Temperature: -10~110°C  
Threaded F/F ISO228/1  
100% leak tested

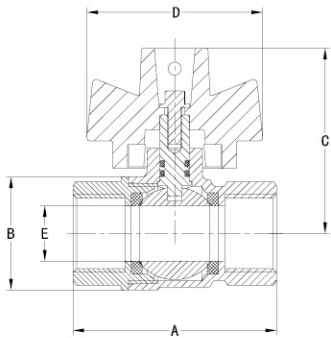

Dimensions

SIZE	A	B	C	D	E
1/2"	60	30.5	50	47.5	15
3/4"	66	35.5	52.5	47.5	19

Packaging

SIZE	Weight(g)	Inner Box(mm)	Carton(mm)	Qty per inner box	Qty per carton
1/2"	206	17x14x8	41x29x18	10	100
3/4"	257	19x14x8	33x29x20	10	80



BV1030-MF | Brass Lock Valve

Specification

Forged brass body  
Sand blast and nickel plated  
Nominal Pressure: Max. 25bar  
Temperature: -10~110°C  
Threaded M/F ISO228/1  
100% leak tested

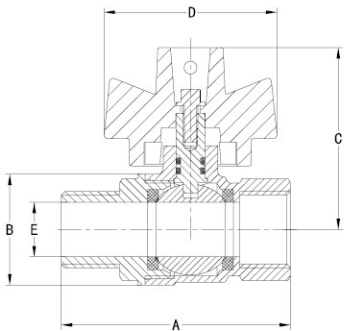

Dimensions

SIZE	A	B	C	D	E
1/2"	66	30.5	50	47.5	15
3/4"	73	35.5	52.5	47.5	19

Packaging

SIZE	Weight(g)	Inner Box(mm)	Carton(mm)	Qty per inner box	Qty per carton
1/2"	210	17x14x8	41x29x18	10	100
3/4"	276	19x14x8	33x29x20	10	80

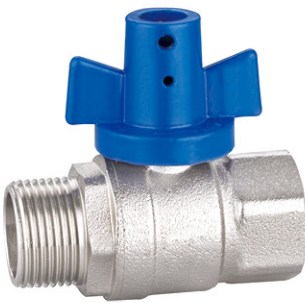

BV1031-FF | Brass Ball Valve

Specification

Forged brass body  
Sand blast and nickel plated  
Nominal Pressure: Max. 25bar  
Temperature: -10~110°C  
Threaded F/F ISO228/1  
100% leak tested

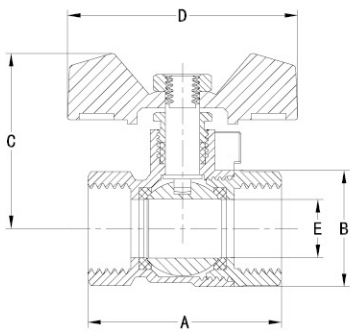

Dimensions

SIZE	A	B	C	D	E
1/2"	45	27	41	53.5	13.5
3/4"	48.5	32	44	53.5	17
1"	60	41	56	67	22.5

Packaging

SIZE	Weight(g)	Inner Box(mm)	Carton(mm)	Qty per inner box	Qty per carton
1/2"	126	17x11.7x6	36x25x19.5	12	144
3/4"	170	17x13.5x7	36x28.5x22.5	10	120
1"	315	17x15x8.3	36x31.5x26.5	8	96



BV1031-MF | Brass Ball Valve

Specification

Forged brass body  
Sand blast and nickel plated  
Nominal Pressure: Max. 25bar  
Temperature: -10~110°C  
Threaded M/F ISO228/1  
100% leak tested

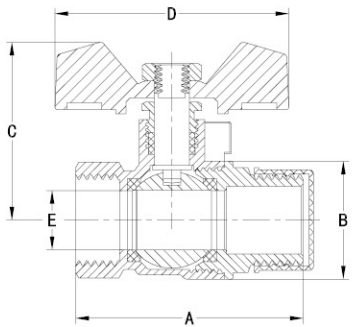

Dimensions

SIZE	A	B	C	D	E
1/2"	52	27	41	53.5	13.5
3/4"	55.5	32	44	53.5	17
1"	68	41	56	67	22.5

Packaging

SIZE	Weight(g)	Inner Box(mm)	Carton(mm)	Qty per inner box	Qty per carton
1/2"	136	17x11.7x6	36x25x19.5	12	144
3/4"	180	17x13.5x7	36x28.5x22.5	10	120
1"	340	17x15x8.3	36x31.5x26.5	8	96





BV1032-MM | Brass Ball Valve

Specification

Forged brass body  
Sand blast and nickel plated  
Nominal Pressure: Max. 25bar  
Temperature: -10~110°C  
Threaded M/M ISO228/1  
100% leak tested

Dimensions

SIZE	A	B	C	D	E
1/2"	53	27	41	53.5	13.5
3/4"	56.5	32	44	53.5	17

Packaging

SIZE	Weight(g)	Inner Box(mm)	Carton(mm)	Qty per inner box	Qty per carton
1/2"	135	17x11.7x6	36x25x19.5	12	144
3/4"	175	17x13.5x7	36x28.5x22.5	10	120

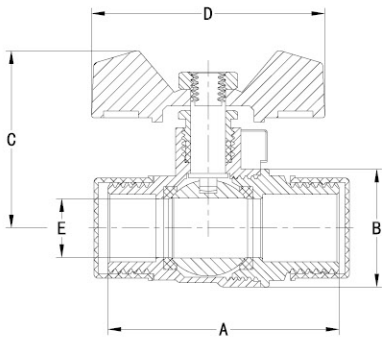

BV1036 | Brass Ball Valve

Specification

Forged brass body  
Sand blast and nickel plated  
Nominal Pressure: Max. 25bar  
Temperature: -10~110°C  
Threaded F/F ISO228/1  
100% leak tested

Dimensions

SIZE	A	B	C	D	E
1/2"	54.5	26.5	52.5	91.5	15
3/4"	56	29	55	91.5	19

Packaging

SIZE	Weight(g)	Inner Box(mm)	Carton(mm)	Qty per inner box	Qty per carton
1/2"	235	17x13.5x7	36x28.5x22.5	6	72
3/4"	295	17x13.5x7	36x28.5x22.5	6	72

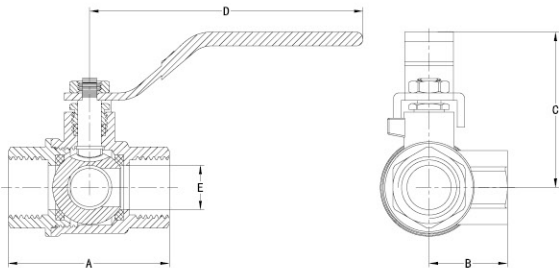

BV1033-FF | Brass Ball Valve

Specification

Forged brass body  
Sand blast and nickel plated  
Nominal Pressure: Max. 25bar  
Temperature: -10~110°C  
Threaded F/F ISO228/1  
100% leak tested

Dimensions

SIZE	A	B	C	D	E
1/2"	45	27	48	97	13.5
3/4"	48.5	32	52	97	17
1"	60	41	60	109	22.5
1 1/4"	68.5	51.5	66.5	140	29
1 1/2"	79.5	60.5	71	140	35
2"	93.5	74	102	165	44.5

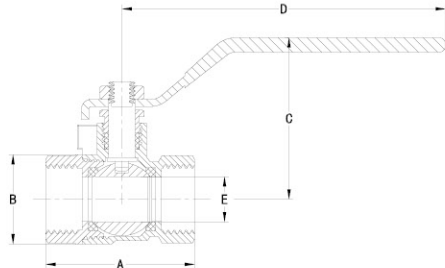

Packaging

SIZE	Weight(g)	Inner Box(mm)	Carton(mm)	Qty per inner box	Qty per carton
1/2"	150	17x13.5x7	36x28.5x22.5	12	144
3/4"	195	17x13.5x7	36x28.5x22.5	10	120
1"	340	15x13x8	32x27.5x25.5	6	72
1 1/4"	535	19x11x9.5	40x23.5x20.5	4	32
1 1/2"	726	19.5x13x10.5	41x27.5x22.5	4	32
2"	1133	22.5x13x8	42x27.5x24	2	20

BV1033-MF | Brass Ball Valve

Specification

Forged brass body  
Sand blast and nickel plated  
Nominal Pressure: Max. 25bar  
Temperature: -10~110°C  
Threaded M/F ISO228/1  
100% leak tested

Dimensions

SIZE	A	B	C	D	E
1/2"	52	27	48	97	13.5
3/4"	55.5	32	52	97	17
1"	68	41	60	109	22.5
1 1/4"	78.5	51.5	66.5	140	29
1 1/2"	88.5	60.5	71	140	35
2"	101.5	74	102	165	44.5

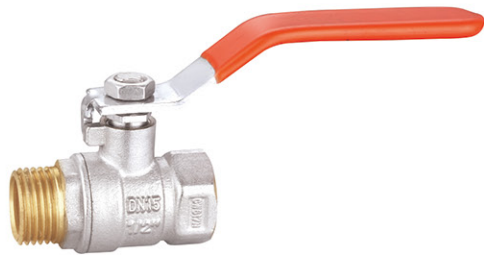
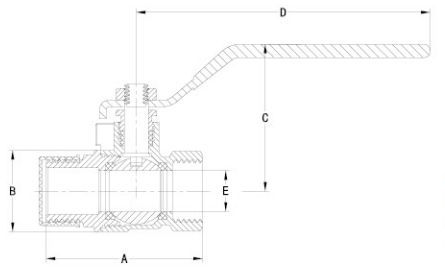

Packaging

SIZE	Weight(g)	Inner Box(mm)	Carton(mm)	Qty per inner box	Qty per carton
1/2"	160	17x13.5x7	36x28.5x22.5	12	144
3/4"	205	17x13.5x7	36x28.5x22.5	10	120
1"	362	15x13x8	32x27.5x25.5	6	72
1 1/4"	572	19x11x9.5	40x23.5x20.5	4	32
1 1/2"	782	19.5x13x10.5	41x27.5x22.5	4	32
2"	1175	22.5x13x8	42x27.5x24	2	20



BV0001 | Iron ball valve

Specification

Forged iron body  
Sand blast and nickel plated  
Nominal Pressure: Max. 25bar  
Temperature: -10~110°C  
Threaded M/F ISO228/1  
100% leak tested

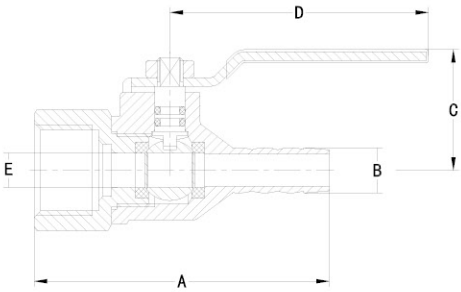

Dimensions

SIZE	A	B	C	D	E
3/8"	68.5	10.5	28	60	8

Packaging

SIZE	Weight(g)	Inner Box(mm)	Carton(mm)	Qty per inner box	Qty per carton
3/8"	125	16x14x4.5	35x23.5x17	12	120

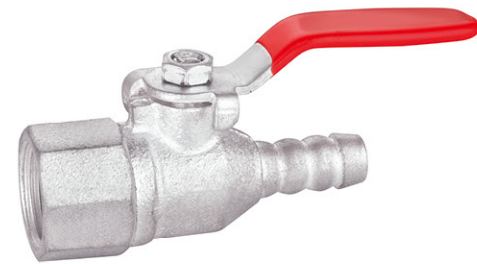

BV0002 | Iron ball valve

Specification

Forged iron body  
Sand blast and nickel plated  
Nominal Pressure: Max. 25bar  
Temperature: -10~110°C  
Threaded M/F ISO228/1  
100% leak tested

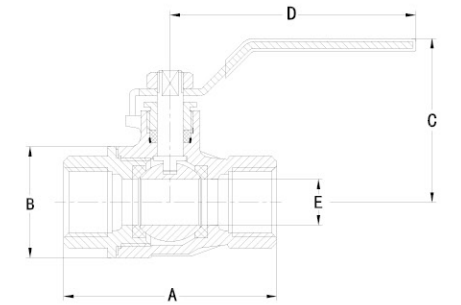

Dimensions

SIZE	A	B	C	D	E
1/2"	65	34	50	75	14

Packaging

SIZE	Weight(g)	Inner Box(mm)	Carton(mm)	Qty per inner box	Qty per carton
1/2"	230	20x13.5x6.5	33.5x28x21	10	100



BV1037 | Brass Ball Valve

Specification

Forged brass body  
Sand blast and nickel plated  
Nominal Pressure: Max. 25bar  
Temperature: -10~110°C  
Threaded ISO228/1  
100% leak tested

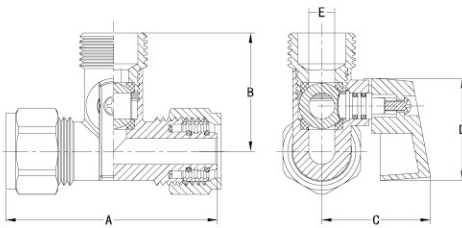

Dimensions

SIZE	A	B	C	D	E
16x1/2"Mx16	64	37	33.5	31.5	8
16x3/4"Mx16	64	39.5	33.5	31.5	8

Packaging

SIZE	Weight(g)	Inner Box(mm)	Carton(mm)	Qty per inner box	Qty per carton
16x1/2"Mx16	179	16x12x5	33.5x25.5x16.5	6	72
16x3/4"Mx16	186	16x12x5	33.5x25.5x16.5	6	72



BV1045-FF | Brass Ball Valve

Specification

Forged brass body  
Sand blast and nickel plated  
Nominal Pressure: Max. 25bar  
Temperature: -10~110°C  
Threaded F/F ISO228/1  
100% leak tested

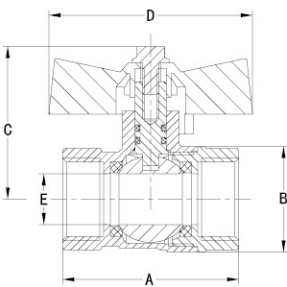

Dimensions

SIZE	A	B	C	D	E
1/4"	39	22	33.5	46	10
3/8"	39	22	33.5	46	10
1/2"	45	27	39	52	13
3/4"	51.5	34	42.5	52	18

Packaging

SIZE	Weight(g)	Inner Box(mm)	Carton(mm)	Qty per inner box	Qty per carton
1/4"	76	14.5x14.5x6	31.5x16.5x30	18	180
3/8"	70	14.5x14.5x6	31.5x15x30.5	18	180
1/2"	126	19x9.5x6.5	34x20.5x20.5	12	120
3/4"	181	21.5x13.5x7.5	39.5x23x28.5	12	120





BV1045-MF | Brass Ball Valve

Specification

Forged brass body  
Sand blast and nickel plated  
Nominal Pressure: Max. 25bar  
Temperature: -10~110°C  
Threaded M/F ISO228/1  
100% leak tested

Dimensions

SIZE	A	B	C	D	E
1/4"	46	22	33	46	10
3/8"	46	22	33	46	10
1/2"	52.5	27	39	52	13
3/4"	58	34	42.5	52	18

Packaging

SIZE	Weight(g)	Inner Box(mm)	Carton(mm)	Qty per inner box	Qty per carton
1/4"	85	14.5x14.5x6	32x15.5x30.5	18	180
3/8"	75	14.5x14.5x6	32x15.5x30.5	18	180
1/2"	135	19x9.5x6.5	34x20.5x20.5	12	120
3/4"	187	21.5x13.5x7.5	39.5x23x28.5	12	120

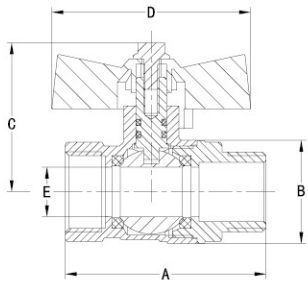

BV1048-MF | Brass Ball Valve

Specification

Forged brass body  
Sand blast and nickel plated  
Nominal Pressure: Max. 25bar  
Temperature: -10~110°C  
Threaded M/F ISO228/1  
100% leak tested

Dimensions

SIZE	A	B	C	D	E
1/2"	63	25.5	41.5	40.5	12

Packaging

SIZE	Weight(g)	Inner Box(mm)	Carton(mm)	Qty per inner box	Qty per carton
1/2"	150	22.5x14x10	43.5x23.5x31.5	14	126

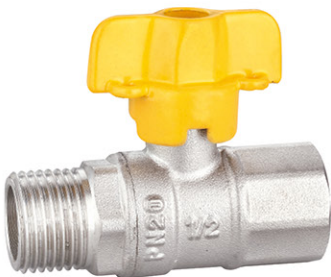
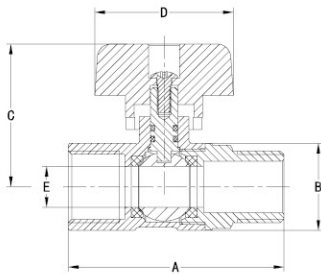

BV1047 | Brass Ball Valve

Specification

Forged brass body  
Sand blast and nickel plated  
Nominal Pressure: Max. 25bar  
Temperature: -10~110°C  
Threaded M/F ISO228/1  
100% leak tested

Dimensions

SIZE	A	B	C	D	E
1/2"	65.5	27	36.5	49	12
3/4"	75	35	41	49	18

Packaging

SIZE	Weight(g)	Inner Box(mm)	Carton(mm)	Qty per inner box	Qty per carton
1/2"	157	14.5x14.5x6	34.5x16x31.5	10	100
3/4"	248	14.5x14.5x6	34.5x16x31.5	10	100

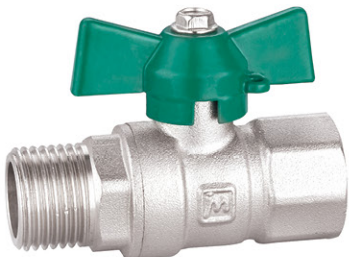
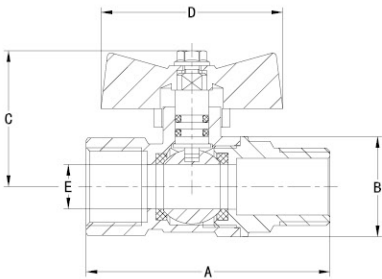

BV1060-MF | Brass Ball Valve

Specification

Forged brass body  
Sand blast and nickel plated  
Nominal Pressure: Max. 25bar  
Temperature: -10~110°C  
Threaded M/F ISO228/1  
100% leak tested

Dimensions

SIZE	A	B	C	D	E
1/2"	45	22	33	30.5	10

Packaging

SIZE	Weight(g)	Inner Box(mm)	Carton(mm)	Qty per inner box	Qty per carton
1/2"	100	29x10x6	31x30x21	10	200

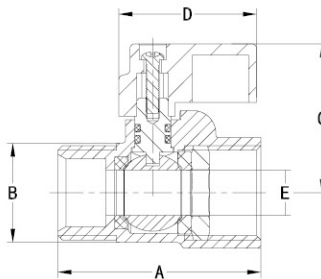



BV1061-F | Brass Ball Valve

Specification

Forged brass body  
Sand blast and nickel plated  
Nominal Pressure: Max. 25bar  
Temperature: -10~110°C  
Threaded ISO228/1  
100% leak tested

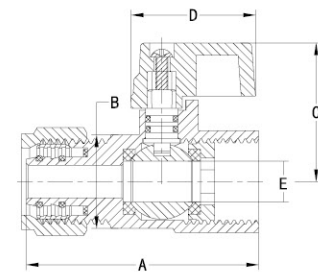

Dimensions

SIZE	A	B	C	D	E
1/2" x16	57	23	34	30.5	10
3/4" x20	72.5	28.5	36.5	30.5	13

Packaging

SIZE	Weight(g)	Inner Box(mm)	Carton(mm)	Qty per inner box	Qty per carton
1/2" x16	152	17x12.5x5	36x26.5x16.5	12	144
3/4" x20	275	15x11.5x5.5	32x24.5x18	6	72

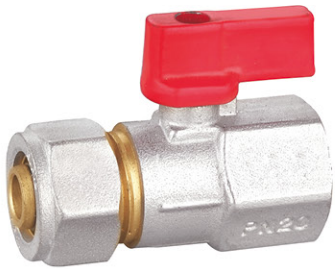

BV1062-M | Brass Ball Valve

Specification

Forged brass body  
Sand blast and nickel plated  
Nominal Pressure: Max. 25bar  
Temperature: -10~110°C  
Threaded M/M ISO228/1  
100% leak tested

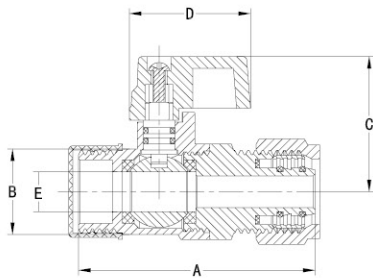

Dimensions

SIZE	A	B	C	D	E
1/2" x16	59.5	22	34	30.5	10
3/4" x20	70.5	28	36.5	30.5	12

Packaging

SIZE	Weight(g)	Inner Box(mm)	Carton(mm)	Qty per inner box	Qty per carton
1/2" x16	147	17x12.5x5	36x26.5x16.5	12	144
3/4" x20	255	15x11.5x5.5	32x24.5x18	6	72



BV1063-MF | Brass Ball Valve

Specification

Forged brass body  
Sand blast and nickel plated  
Nominal Pressure: Max. 25bar  
Temperature: -10~110°C  
Threaded M/F ISO228/1  
100% leak tested

Dimensions

SIZE	A	C	D	E
1/8"	36.5	23.3	32.6	6
1/4"	36.5	23.3	32.6	6
3/8"	38	26.5	32.6	8
1/2"	42.5	28.5	32.6	10

Packaging

SIZE	Weight(g)	Inner Box(mm)	Carton(mm)	Qty per inner box	Qty per carton
1/8"	70	14.5x14.5x6	31.5x16.5x31	30	300
1/4"	75	14.5x14.5x6	31.5x16.5x31	30	300
3/8"	70	14.5x14.5x6	31.5x16.5x31	30	300
1/2"	105	14.5x14.5x6	31.5x16.5x31	24	240

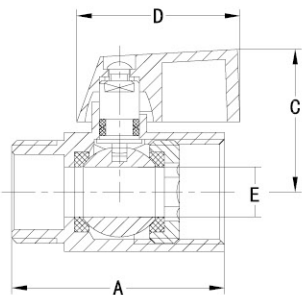

BV1065-FF | Brass Ball Valve

Specification

Forged brass body  
Sand blast and nickel plated  
Nominal Pressure: Max. 25bar  
Temperature: -10~110°C  
Threaded F/F ISO228/1  
100% leak tested

Dimensions

SIZE	A	C	D	E
1/4"	36.5	23.3	32.6	6
3/8"	36.5	23.3	32.6	6
1/2"	38	26.5	32.6	8

Packaging

SIZE	Weight(g)	Inner Box(mm)	Carton(mm)	Qty per inner box	Qty per carton
1/4"	88	14.5x14.5x6	31.5x16.5x31	30	300
3/8"	75	14.5x14.5x6	31.5x16.5x31	30	300
1/2"	106	14.5x14.5x6	31.5x16.5x31	24	240

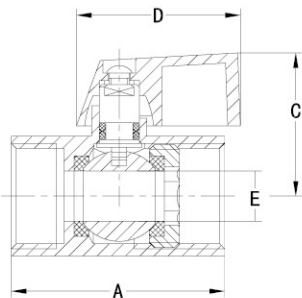



Brass Ball Valve

BV1067-MM | Brass Ball Valve

Specification

Forged brass body  
Sand blast and nickel plated  
Nominal Pressure: Max. 25bar  
Temperature: -10~110°C  
Threaded M/M ISO228/1  
100% leak tested

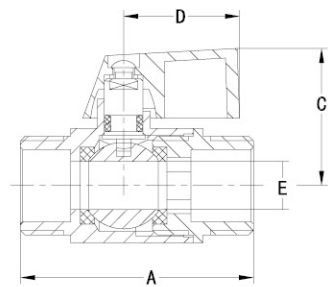

Dimensions

SIZE	A	C	D	E
1/4"	46	26.5	24	8
3/8"	46	26.5	24	8
1/2"	48.5	28.5	24	10

Packaging

SIZE	Weight(g)	Inner Box(mm)	Carton(mm)	Qty per inner box	Qty per carton
1/4"	77	14.5x14.5x6	31.5x16.5x31	30	300
3/8"	81	14.5x14.5x6	31.5x16.5x31	30	300
1/2"	111	14.5x14.5x6	31.5x16.5x31	24	240

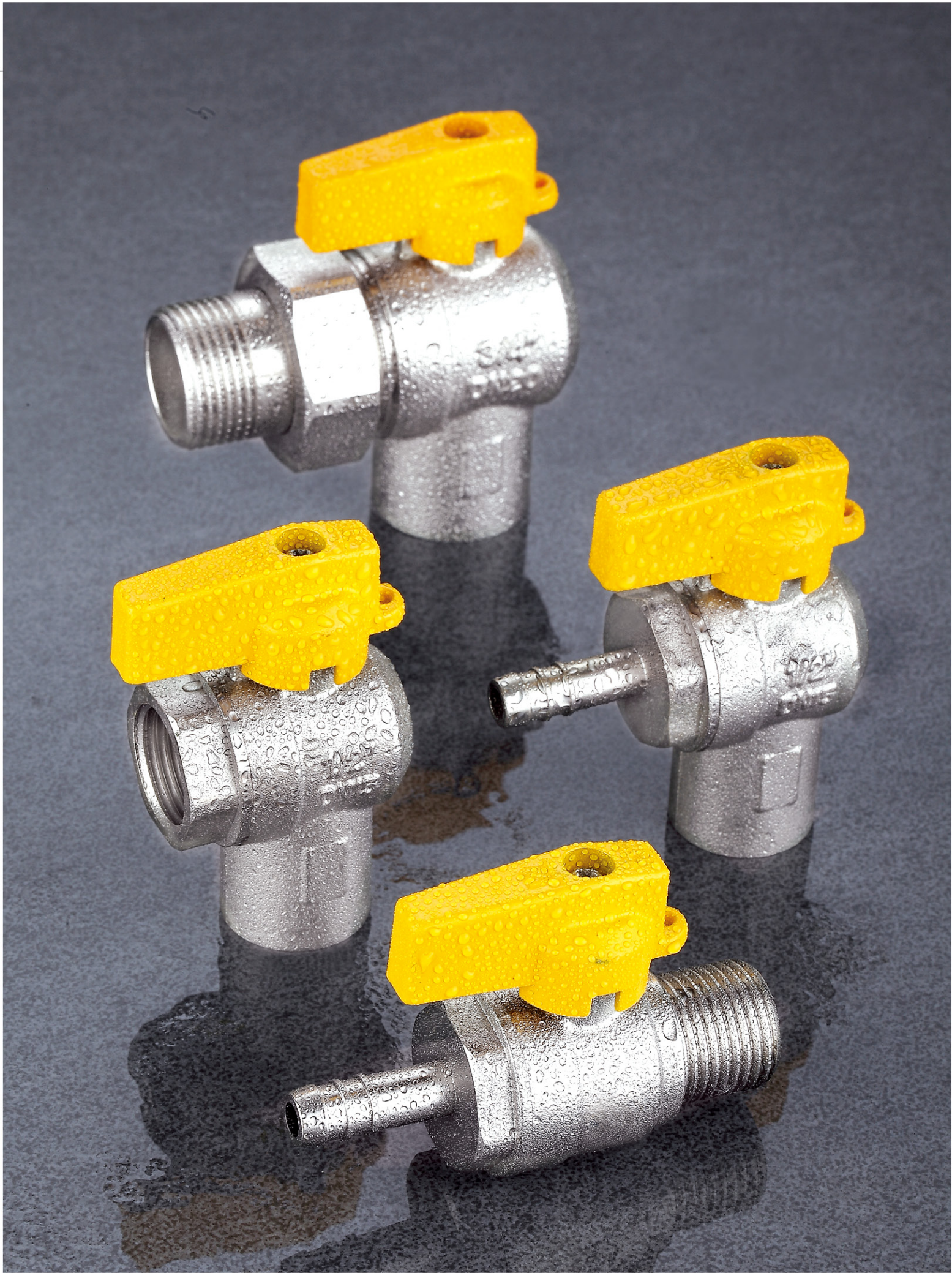



AV1005-FF | Brass Gas Ball Valve

Specification

Forged brass body  
Sand blast and nickel plated  
Nominal Pressure: Max. 25bar  
Temperature: -10~110°C  
Threaded F/F ISO228/1  
100% leak tested

Dimensions

SIZE	A	B	C	D	E
1/2"x1/2"	24	36	38	43	15
3/4"x1/2"	27.5	38	40.5	43	18
3/4"x3/4"	28	38	40.5	43	18

Packaging

SIZE	Weight(g)	Inner Box(mm)	Carton(mm)	Qty per inner box	Qty per carton
1/2"x1/2"	190	18.5x18x6	37x25x19.5	10	80
3/4"x1/2"	258	18.5x18x6	37x25x19.5	10	80
3/4"x3/4"	257	18.5x18x6	37x25x19.5	10	80

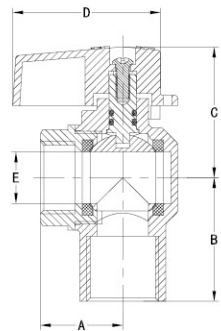

AV1006-MF | Brass Gas Ball Valve

Specification

Forged brass body  
Sand blast and nickel plated  
Nominal Pressure: Max. 25bar  
Temperature: -10~110°C  
Threaded M/F ISO228/1  
100% leak tested

Dimensions

SIZE	A	B	C	D	E
1/2"x1/2"	33	36	38	43	15
3/4"x1/2"	36	38	40.5	43	18
3/4"x3/4"	36	38	40.5	43	18

Packaging

SIZE	Weight(g)	Inner Box(mm)	Carton(mm)	Qty per inner box	Qty per carton
1/2"x1/2"	205	18.5x18x6	37x25x19.5	10	80
3/4"x1/2"	268	18.5x18x6	37x25x19.5	10	80
3/4"x3/4"	272	18.5x18x6	37x25x19.5	10	80

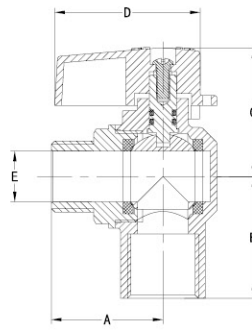

AV1005-MF | Brass Gas Ball Valve

Specification

Forged brass body  
Sand blast and nickel plated  
Nominal Pressure: Max. 25bar  
Temperature: -10~110°C  
Threaded M/F ISO228/1  
100% leak tested

Dimensions

SIZE	A	B	C	D	E
1/2"x1/2"	24	36	38	43	15
3/4"x1/2"	27.5	38	40.5	43	18
3/4"x3/4"	28	38	40.5	43	18

Packaging

SIZE	Weight(g)	Inner Box(mm)	Carton(mm)	Qty per inner box	Qty per carton
1/2"x1/2"	194	18.5x18x6	37x25x19.5	10	80
3/4"x1/2"	263	18.5x18x6	37x25x19.5	10	80
3/4"x3/4"	262	18.5x18x6	37x25x19.5	10	80

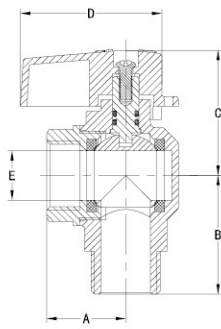

AV1006-MM | Brass Gas Ball Valve

Specification

Forged brass body  
Sand blast and nickel plated  
Nominal Pressure: Max. 25bar  
Temperature: -10~110°C  
Threaded M/M ISO228/1  
100% leak tested

Dimensions

SIZE	A	B	C	D	E
1/2"x1/2"	33	36	38	43	15
3/4"x1/2"	36	38	40.5	43	18
3/4"x3/4"	36	38	40.5	43	18

Packaging

SIZE	Weight(g)	Inner Box(mm)	Carton(mm)	Qty per inner box	Qty per carton
1/2"x1/2"	208	18.5x18x6	37x25x19.5	10	80
3/4"x1/2"	273	18.5x18x6	37x25x19.5	10	80
3/4"x3/4"	279	18.5x18x6	37x25x19.5	10	80

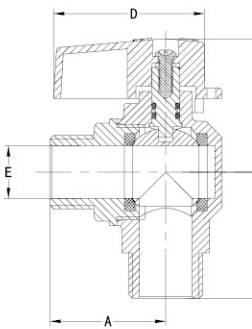



AV1007-FF | Brass Gas Ball Valve

Specification

Forged brass body  
Sand blast and nickel plated  
Nominal Pressure: Max. 25bar  
Temperature: -10~110°C  
Threaded F/F ISO228/1  
100% leak tested

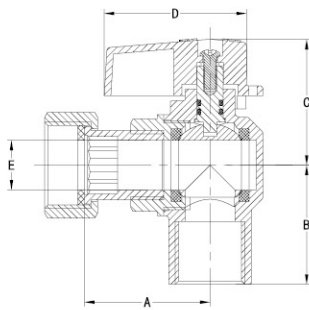

Dimensions

SIZE	A	B	C	D	E
1/2"x3/4"	38	36	38	43	15

Packaging

SIZE	Weight(g)	Inner Box(mm)	Carton(mm)	Qty per inner box	Qty per carton
1/2"x3/4"	248	17x12x8.5	35x25x18	10	80



AV1007-MF | Brass Gas Ball Valve

Specification

Forged brass body  
Sand blast and nickel plated  
Nominal Pressure: Max. 25bar  
Temperature: -10~110°C  
Threaded M/F ISO228/1  
100% leak tested

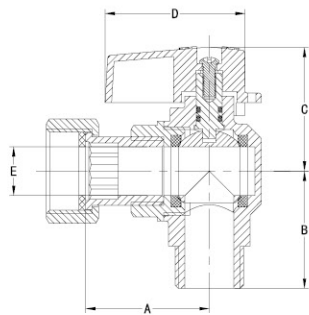

Dimensions

SIZE	A	B	C	D	E
1/2"x3/4"	38	36	38	43	15

Packaging

SIZE	Weight(g)	Inner Box(mm)	Carton(mm)	Qty per inner box	Qty per carton
1/2"x3/4"	251	17x12x8.5	35x25x18	10	80



AV1008-MF | Brass Gas Ball Valve

Specification

Forged brass body  
Sand blast and nickel plated  
Nominal Pressure: Max. 25bar  
Temperature: -10~110°C  
Threaded M/F ISO228/1  
100% leak tested

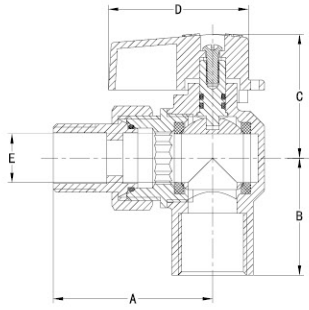

Dimensions

SIZE	A	B	C	D	E
1/2" x1/2"	50	36	38	43	15
3/4" x3/4"	54.5	38	40.5	43	18

Packaging

SIZE	Weight(g)	Inner Box(mm)	Carton(mm)	Qty per inner box	Qty per carton
1/2" x1/2"	257	21.5x8.5x9	43.5x19x22.5	5	50
3/4" x3/4"	367	21.5x8.5x9	43.5x19x22.5	5	50



AV1008-MM | Brass Gas Ball Valve

Specification

Forged brass body  
Sand blast and nickel plated  
Nominal Pressure: Max. 25bar  
Temperature: -10~110°C  
Threaded M/M ISO228/1  
100% leak tested

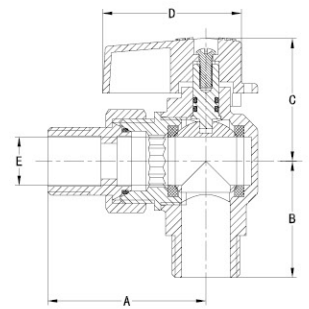

Dimensions

SIZE	A	B	C	D	E
1/2" x1/2"	50	36	38	43	15
3/4" x3/4"	54.5	38	40.5	43	18

Packaging

SIZE	Weight(g)	Inner Box(mm)	Carton(mm)	Qty per inner box	Qty per carton
1/2" x1/2"	258	21.5x8.5x9	43.5x19x22.5	5	50
3/4" x3/4"	372	21.5x8.5x9	43.5x19x22.5	5	50





AV1009-FF | Brass Gas Ball Valve

Specification

Forged brass body  
Sand blast and nickel plated  
Nominal Pressure: Max. 25bar  
Temperature: -10~110°C  
Threaded F/F ISO228/1  
100% leak tested

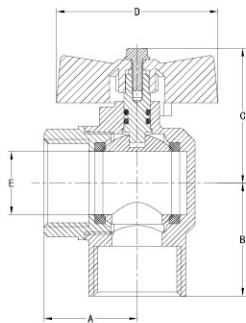

Dimensions

SIZE	A	B	C	D	E
1"x1"	35.5	43	51	61.5	24

Packaging

SIZE	Weight(g)	Inner Box(mm)	Carton(mm)	Qty per inner box	Qty per carton
1"x1"	457	22.5x11x7	29x23.5x23	5	40

AV1009-MF | Brass Gas Ball Valve

Specification

Forged brass body  
Sand blast and nickel plated  
Nominal Pressure: Max. 25bar  
Temperature: -10~110°C  
Threaded M/F ISO228/1  
100% leak tested

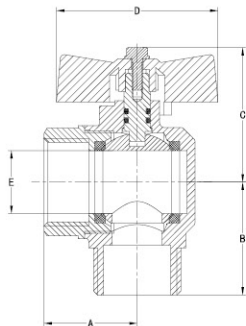

Dimensions

SIZE	A	B	C	D	E
1"x1"	35.5	48	51	61.5	24

Packaging

SIZE	Weight(g)	Inner Box(mm)	Carton(mm)	Qty per inner box	Qty per carton
1"x1"	475	22.5x11x7	29x23.5x23	5	40

BV1029-F | Brass Gas Ball Valve

Specification

Forged brass body  
Sand blast and nickel plated  
Nominal Pressure: Max. 25bar  
Temperature: -10~110°C  
Threaded ISO228/1  
100% leak tested

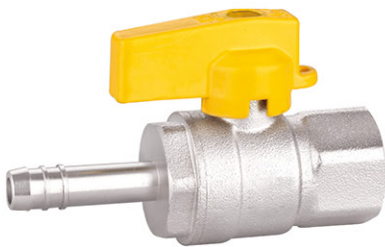
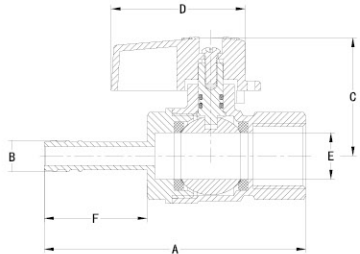

Dimensions

SIZE	A	B	C	D	E	F
1/4"Fx9	66.5	9	29	33	9	25
1/2"Fx9	76	9	38	43	15	25
1/2"Fx9.5	76	9.5	38	43	15	25
1/2"Fx10	84	10	38	43	15	33
1/2"Fx10.5	84	10.5	38	43	15	33
1/2"Fx11.8	84	11.8	38	43	15	33
1/2"Fx14	95.5	14	38	43	15	44.5
1/2"Fx15	95.5	15	38	43	15	44.5

Packaging

SIZE	Weight(g)	Inner Box(mm)	Carton(mm)	Qty per inner box	Qty per carton
1/4"Fx9	91	19x8x6	31x20x17	6	60
1/2"Fx9	194	19x8x6	31x20x17	6	60
1/2"Fx9.5	194	19x10x6	31x21x20	6	60
1/2"Fx10	197	19x10x6	31x21x20	6	60
1/2"Fx10.5	197	19x10x6	31x21x20	6	60
1/2"Fx11.8	198	19x10x6	31x21x20	6	60
1/2"Fx14	206	19x10x6	31x21x20	6	60
1/2"Fx15	207	19x11x6	31x23x20	6	60

BV1029-M | Brass Gas Ball Valve

Specification

Forged brass body  
Sand blast and nickel plated  
Nominal Pressure: Max. 25bar  
Temperature: -10~110°C  
Threaded ISO228/1  
100% leak tested

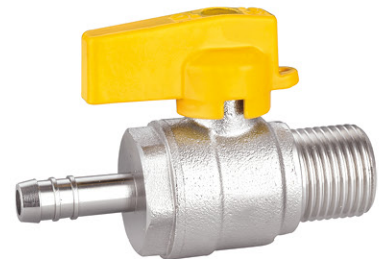
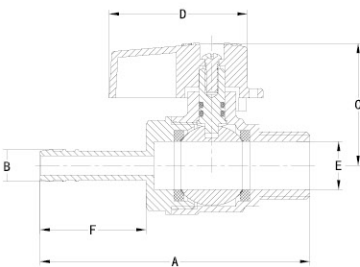

Dimensions

SIZE	A	B	C	D	E	F
1/4"Mx9	66.5	9	29	33	9	25
1/2"Mx9	78	9	38	43	15	25
1/2"Mx9.5	78	9.5	38	43	15	25
1/2"Mx10	86	10	38	43	15	33
1/2"Mx10.5	86	10.5	38	43	15	33
1/2"Mx11.8	86	11.8	38	43	15	33
1/2"Mx14	97.5	14	38	43	15	44.5
1/2"Mx15	97.5	15	38	43	15	44.5

Packaging

SIZE	Weight(g)	Inner Box(mm)	Carton(mm)	Qty per inner box	Qty per carton
1/4"Mx9	84	19x8x6	31x20x17	6	60
1/2"Mx9	184	19x8x6	31x20x17	6	60
1/2"Mx9.5	184	19x10x6	31x21x20	6	60
1/2"Mx10	187	19x10x6	31x21x20	6	60
1/2"Mx10.5	187	19x10x6	31x21x20	6	60
1/2"Mx11.8	188	19x10x6	31x21x20	6	60
1/2"Mx14	196	19x11x6	31x23x20	6	60
1/2"Mx15	197	19x11x6	31x23x20	6	60



AV1010-F | Brass Gas Ball Valve

Specification

Forged brass body  
Sand blast and nickel plated  
Nominal Pressure: Max. 25bar  
Temperature: -10~110°C  
Threaded ISO228/1  
100% leak tested

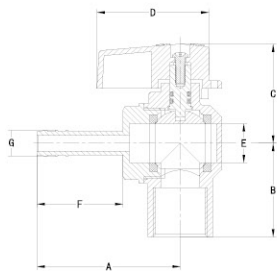

Dimensions

SIZE	A	B	C	D	E	F	G
1/2"x9	47	36	38	43	15	25	9
1/2"x9.5	47	36	38	43	15	25	9.5
1/2"x10	55	36	38	43	15	33	10
1/2"x10.5	55	36	38	43	15	33	10.5
1/2"x11.8	55	36	38	43	15	33	11.8
1/2"x14	66.5	36	38	43	15	44.5	14
1/2"x15	66.5	36	38	43	15	44.5	15

Packaging

SIZE	Weight(g)	Inner Box(mm)	Carton(mm)	Qty per inner box	Qty per carton
1/2"x9	206	19x9x9	37x20x19	6	48
1/2"x9.5	206	19x9x9	37x20x19	6	48
1/2"x10	209	19x9x9	37x20x19	6	48
1/2"x10.5	210	19x9x9	37x20x19	6	48
1/2"x11.8	211	19x9x9	37x20x19	6	48
1/2"x14	219	19x10x9	37x21x20	6	48
1/2"x15	220	19x10x9	37x21x20	6	48

AV1010-M | Brass Gas Ball Valve

Specification

Forged brass body  
Sand blast and nickel plated  
Nominal Pressure: Max. 25bar  
Temperature: -10~110°C  
Threaded ISO228/1  
100% leak tested

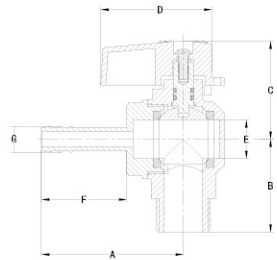

Dimensions

SIZE	A	B	C	D	E	F	G
1/2"x9	47	36	38	43	15	25	9
1/2"x9.5	47	36	38	43	15	25	9.5
1/2"x10	55	36	38	43	15	33	10
1/2"x10.5	55	36	38	43	15	33	10.5
1/2"x11.8	55	36	38	43	15	33	11.8
1/2"x14	66.5	36	38	43	15	44.5	14
1/2"x15	66.5	36	38	43	15	44.5	15

Packaging

SIZE	Weight(g)	Inner Box(mm)	Carton(mm)	Qty per inner box	Qty per carton
1/2"x9	209	19x8x9	37x17x20	6	48
1/2"x9.5	209	19x8x9	37x17x20	6	48
1/2"x10	212	19x9x9	37x20x19	6	48
1/2"x10.5	213	19x9x9	37x20x19	6	48
1/2"x11.8	214	19x9x9	37x20x19	6	48
1/2"x14	222	19x10x9	37x21x20	6	48
1/2"x15	223	19x10x9	37x21x20	6	48

AV1011-MF | Brass Angle Valve

Specification

Forged brass body  
Sand blast and nickel plated  
Nominal Pressure: Max. 25bar  
Temperature: -10~110°C  
Threaded M/F ISO228/1  
100% leak tested

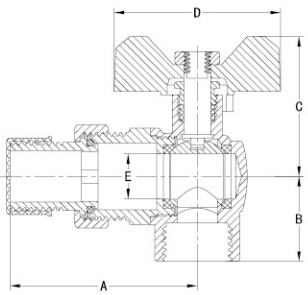

Dimensions

SIZE	A	B	C	D	E
1/2" x1/2"	54	25.5	42	50	13.5
3/4" x3/4"	63	32.5	47	50	19

Packaging

SIZE	Weight(g)	Carton(mm)	Qty per carton
1/2" x1/2"	198	34x31.5x22.5	120
3/4" x3/4"	360	39x27.5x27	72

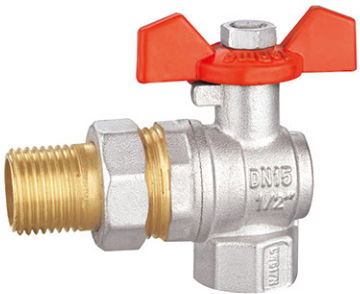

AV1012 | Brass Angle Valve

Specification

Forged brass body  
Sand blast and nickel plated  
Nominal Pressure: Max. 25bar  
Temperature: -10~110°C  
Threaded M/M ISO228/1  
100% leak tested

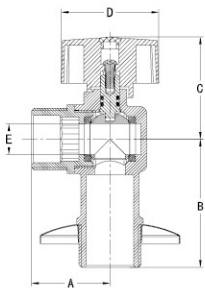

Dimensions

SIZE	A	B	C	D	E
3/4"x3/4"	33	54	43	41	13

Packaging

SIZE	Weight(g)	Inner Box(mm)	Carton(mm)	Qty per inner box	Qty per carton
3/4"x3/4"	255	16x11x6.5	33.5x23x17	5	50





Brass Angle Valve

AV3010 | Brass Angle Valve

Specification

Forged brass body  
Sand blast and nickel plated  
Nominal Pressure: Max. 25bar  
Temperature: -10~110°C  
Threaded M/M ISO228/1  
100% leak tested

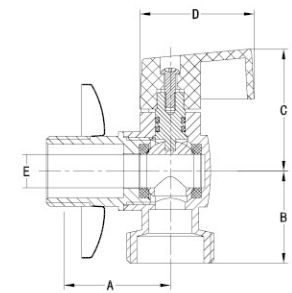

Dimensions

SIZE	A	B	C	D	E
1/2"x1/2"	37	27.5	36.5	34	10
3/4"x3/4"	37	27.5	36.5	34	10

Packaging

SIZE	Weight(g)	Inner Box(mm)	Carton(mm)	Qty per inner box	Qty per carton
1/2"x1/2"	112	6.5x3.5x6.3	34x33x30	1	200
3/4"x3/4"	120	6.5x3.5x6.3	34x33x30	1	200



AV3033 | Brass Angle Valve

Specification

Forged brass body  
Sand blast and nickel plated  
Nominal Pressure: Max. 25bar  
Temperature: -10~110°C  
Threaded M/M ISO228/1  
100% leak tested

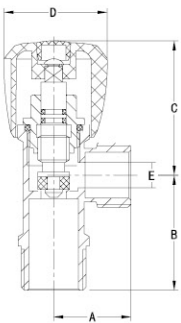

Dimensions

SIZE	A	B	C	D	E
1/2"x1/2"	24.5	36.5	42.5	34	8

Packaging

SIZE	Weight(g)	Inner Box(mm)	Carton(mm)	Qty per inner box	Qty per carton
1/2"x1/2"	112	18x10.5x7.5	39x22.5x18.5	10	100





CV5004 | Brass Check Valve

Specification

Forged brass body  
Sand blast  
Nominal Pressure: Max. 25bar  
Temperature: -10~110°C  
Threaded ISO228/1  
100% leak tested

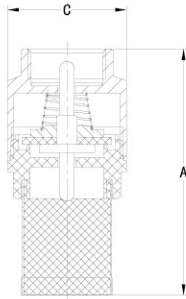

Dimensions

SIZE	A	C
1/2"	66	31.9
3/4"	78	38.9
1"	85.5	42
1 1/4"	101	57.6
1 1/2"	118.5	64.5
2"	128	78.7
2 1/2"	154.4	97
3"	171	111
4"	184.5	140.4

Packaging

SIZE	Weight(g)	Inner Box(mm)	Carton(mm)	Qty per inner box	Qty per carton
1/2"	59	21.5x13.5x7.5	40x22x28.5	26	260
3/4"	90	21.5x13.5x7.5	40x22x28.5	15	150
1"	119	22x14x8.5	44x23.5x29	12	120
1 1/4"	235	30.5x10.7x10.7	56x32x23.5	9	90
1 1/2"	302	21.5x13.5x7.5	42x22.5x39	3	45
2"	462	22x14x8.5	22x23.5x29	3	30
2 1/2"	950	33x23x12	47.5x34x36.5	4	20
3"	1224	35x20x14.5	40x35x29	3	12
4"	1916	35x20x14.5	40x35x29	2	8

CV5005-A | Brass Check Valve

Specification

Forged brass body  
Sand blast  
Nominal Pressure: Max. 25bar  
Temperature: -10~110°C  
Threaded F/F ISO228/1  
100% leak tested

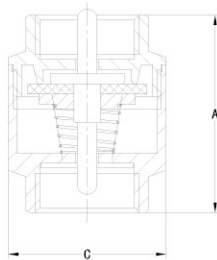

Dimensions

SIZE	A	C
1/2"	40	31.9
3/4"	42.3	38.9
1"	53.5	42.4
1 1/4"	63.5	57.6
1 1/2"	71	65.5
2"	75.5	79.3
2 1/2"	98.5	97.4
3"	102.5	110.3

Packaging

SIZE	Weight(g)	Inner Box(mm)	Carton(mm)	Qty per inner box	Qty per carton
1/2"	92	18x9.5x5.5	37.5x20.5x29	10	200
3/4"	133	18x9.5x5.5	37.5x20.5x29	6	120
1"	186	18x9.5x5.5	37.5x20.5x29	5	100
1 1/4"	375	14.5x14.5x6	31x16.5x16	4	40
1 1/2"	530	21.5x13.5x7.5	39x22x28.5	6	60
2"	820	23x12x11	47.5x34.5x25.5	3	30
2 1/2"	1720	30.5x10.5x10.5	32x22x22.5	3	12
3"	2200	23x12x11	24.5x23.5x12.5	2	4

CV5005-B | Brass Check Valve

Specification

Forged brass body  
Sand blast  
Nominal Pressure: Max. 25bar  
Temperature: -10~110°C  
Threaded F/F ISO228/1  
100% leak tested

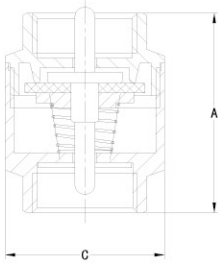

Dimensions

SIZE	A	C
1/2"	40	31.9
3/4"	42.3	38.9
1"	53.5	42.4
1 1/4"	63.5	57.6
1 1/2"	71	65.5
2"	75.5	79.3
2 1/2"	98.5	97.4
3"	102.5	110.3
4"	117.5	140.4

Packaging

SIZE	Weight(g)	Inner Box(mm)	Carton(mm)	Qty per inner box	Qty per carton
1/2"	80	18x9.5x5.5	37.5x20.5x29	15	300
3/4"	120	18x9.5x5.5	37.5x20.5x29	8	160
1"	165	18x9.5x9.5	37.5x20x29	6	120
1 1/4"	326	14.5x14.5x6	31x16.5x16	4	40
1 1/2"	453	21.5x13.5x7.5	40x22x28.5	6	60
2"	692	23x12x11	57x26x25	5	30
2 1/2"	1390	30.5x10.7x10.7	34x32.5x24	3	15
3"	1800	23x12x11	39x22x18.5	2	10
4"	2900	33x23x12	47.5x34x13	2	4

CV5006 | Brass Check Valve

Specification

Forged brass body  
Sand blast  
Nominal Pressure: Max. 25bar  
Temperature: -10~110°C  
Threaded F/F ISO228/1  
100% leak tested

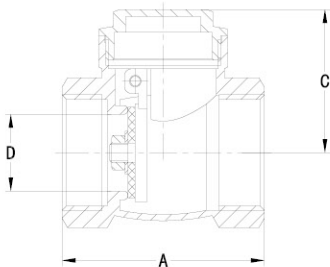

Dimensions

SIZE	A	C	D
1/2"	45	30.5	13
3/4"	50.2	35.5	17
1"	58	41	22
1 1/4"	68.8	48.5	29
1 1/2"	53	75	34
2"	91	64	46
2 1/2"	113	79.5	57
3"	122	91	65
4"	158	111.5	86

Packaging

SIZE	Weight(g)	Inner Box(mm)	Carton(mm)	Qty per inner box	Qty per carton
1/2"	125	19.5x10x5	27x21x31.5	12	180
3/4"	181	19x9.5x6.5	34x20.5x20.5	9	90
1"	285	19x9.5x6.5	34x20.5x20.5	6	60
1 1/4"	422	21.5x13.5x7.5	39x22x28.5	6	60
1 1/2"	545	16.5x13x8	41.5x18x27.5	4	40
2"	1150	21.5x11x7.5	39x22x34.5	2	30
2 1/2"	2000	13.5x1x13.6	32x26x33.5	1	8
3"	2300	30x15x12.5	31x15.5x26.5	3	6
4"	4300	19x16.5x12.5	43.5x37.5x20	1	6



SV5020 | Brass Gate Valve

Specification

Forged brass body  
Sand blast and nickel plated  
Nominal Pressure: Max. 25bar  
Temperature: -10~110°C  
Threaded F/F ISO228/1  
100% leak tested

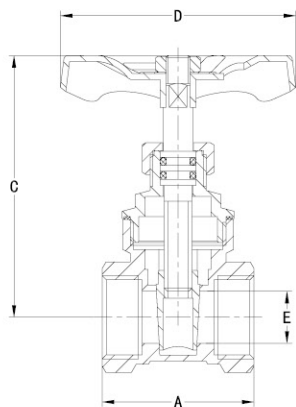

Dimensions

SIZE	A	C	D	E
1/2"	36	60.5	59	15
3/4"	41	67	59	19
1"	45	75	59	23
1 1/4"	43	87	72	26
1 1/2"	50	103	72	36
2"	56.5	115	78	44
2 1/2"	60	147	99	56
3"	69	171	106	67
4"	89.5	204.5	126	88

Packaging

SIZE	Weight(g)	Inner Box(mm)	Carton(mm)	Qty per inner box	Qty per carton
1/2"	165	20x9.3x9.5	39.5x21x29.5	12	120
3/4"	235	20x9.3x9.5	39.5x21x29.5	8	96
1"	300	28.5x12.5x6.5	34x29x26.5	8	80
1 1/4"	400	24x15.5x8.5	44.5x25x30.5	5	50
1 1/2"	590	24x15.5x8.5	44.5x25x30.5	4	40
2"	900	15x16.5x8.5	34.5x31.5x27.5	2	24
2 1/2"	1660	20x9.3x9.3	36.5x21x29.5	1	12
3"	2250	23.3x9.9x9.9	41.5x24.5x31.5	1	12
4"	4215	29x12.6x12.6	39.5x30.5x26.5	1	6

FT1001 | Brass Filter Valve

Specification

Forged brass body  
Sand blast  
Nominal Pressure: Max. 25bar  
Temperature: -10~110°C  
Threaded F/F ISO228/1  
100% leak tested

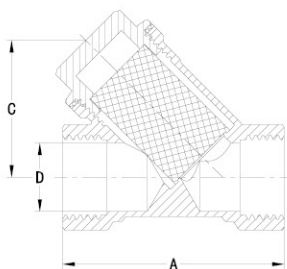

Dimensions

SIZE	A	C	D
1/2"	55	34	17
3/4"	66	38	20
1"	77	41	26.5
1 1/4"	86	54	33.5
1 1/2"	99	59.5	41
2"	115	76	48

Packaging

SIZE	Weight(g)	Carton(mm)	Qty per carton
1/2"	130	33x23x18	160
3/4"	200	33x23x18	100
1"	270	36x25x19.5	80
1 1/4"	565	33x23x18	28
1 1/2"	728	33x23x18	21
2"	1355	33x23x18	10

FV5001 | Brass Foot Valve

Specification

Forged brass body  
Sand blast  
Nominal Pressure: Max. 25bar  
Temperature: -10~110°C  
Threaded F/F ISO228/1  
100% leak tested

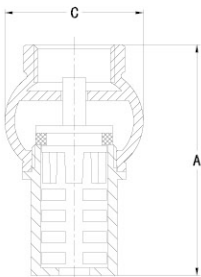

Dimensions

SIZE	A	C
1/2"	60	36
3/4"	69.5	42
1"	80.5	52
1 1/4"	85.5	58
1 1/2"	87.5	62
2"	100	72.5
2 1/2"	123	94
3"	152	116
4"	195	148

Packaging

SIZE	Weight(g)	Inner Box(mm)	Carton(mm)	Qty per inner box	Qty per carton
1/2"	120	20.5x7x6	35x23x17	12	120
3/4"	180	16.5x13x8	42x35x15	9	90
1"	235	17x13x8.5	37x28x18.5	10	80
1 1/4"	340	19x9.5x6.5	36x21.5x21.5	3	30
1 1/2"	430	19x9.5x6.5	36x21.5x21.5	3	30
2"	640	22.5x12.5x8	42.5x25x27.5	3	30
2 1/2"	1150	29x10x13	42x30.5x28	3	24
3"	1700	35.5x12x16.5	37x18x25.5	3	6
4"	3500	14.5x14.5x18.5	31x31x20	1	4



FT1002 | Brass Filter Valve

Specification

Forged brass body  
Sand blast  
Nominal Pressure: Max. 25bar  
Temperature: -10~110°C  
Threaded M/F ISO228/1  
100% leak tested

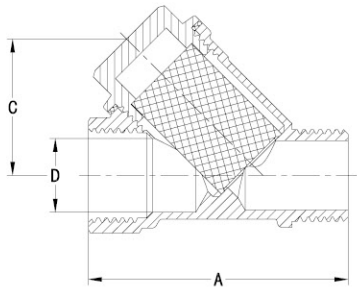

Dimensions

SIZE	A	C	D
1/2"	58	30	17

Packaging

SIZE	Weight(g)	Carton(mm)	Qty per carton
1/2"	120	33x23x18	120



FT1003 | Brass Filter Valve

Specification

Forged brass body  
Sand blast  
Nominal Pressure: Max. 25bar  
Temperature: -10~110°C  
Threaded M/M ISO228/1  
100% leak tested

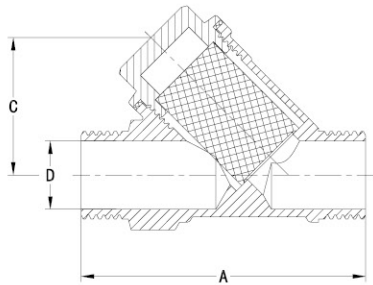

Dimensions

SIZE	A	C	D
1/2"	67	32	16

Packaging

SIZE	Weight(g)	Carton(mm)	Qty per carton
1/2"	140	33x23x18	120

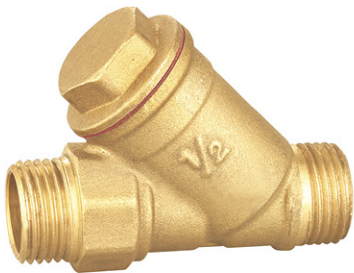

FT1004 | Brass Filter Valve

Specification

Forged brass body  
Sand blast  
Nominal Pressure: Max. 25bar  
Temperature: -10~110°C  
Threaded F/F ISO228/1  
100% leak tested

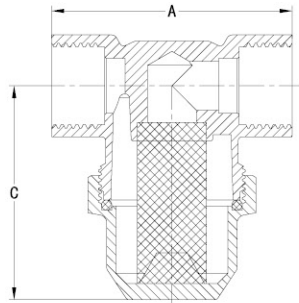

Dimensions

SIZE	A	C
1/2"	59	52.5
3/4"	64	54

Packaging

SIZE	Weight(g)	Carton(mm)	Qty per carton
1/2"	253	33x23x18	100
3/4"	394	33x23x18	50



FT1005 | Brass Filter Valve

Specification

Forged brass body  
Sand blast  
Nominal Pressure: Max. 25bar  
Temperature: -10~110°C  
Threaded M/F ISO228/1  
100% leak tested

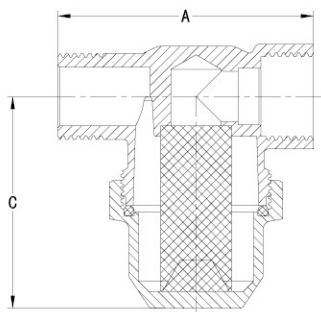

Dimensions

SIZE	A	C
1/2"	61	50.5
3/4"	71.5	53

Packaging

SIZE	Weight(g)	Carton(mm)	Qty per carton
1/2"	237	33x23x18	100
3/4"	405	33x23x18	50





FT1006 | Brass Filter Valve

Specification

Forged brass body  
Sand blast and nickel plated  
Nominal Pressure: Max. 25bar  
Temperature: -10~110°C  
Threaded M/F ISO228/1  
100% leak tested

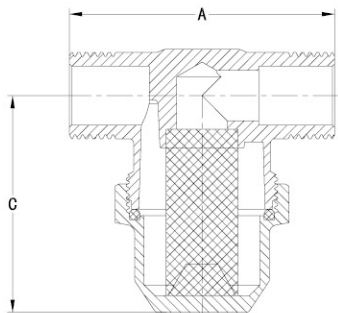

Dimensions

SIZE	A	C
1/2"	63	51.5

Packaging

SIZE	Weight(g)	Carton(mm)	Qty per carton
1/2"	250	33x23x18	100

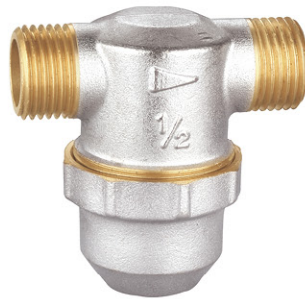

FT1007 | Brass Filter Valve

Specification

Forged brass body  
Sand blast and nickel plated  
Nominal Pressure: Max. 25bar  
Temperature: -10~110°C  
Threaded F/F ISO228/1  
100% leak tested

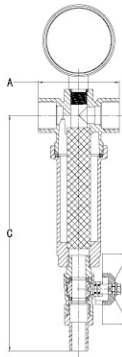

Dimensions

SIZE	A	C
1/2"	65	200
3/4"	67	200

Packaging

SIZE	Weight(g)	Carton(mm)	Qty per carton
1/2"	650	37x20x31	20
3/4"	720	37x29x31	20



BC2002 | Brass Bibcock

Specification

Forged brass body  
Sand blast and nickel plated  
Nominal Pressure: Max. 25bar  
Temperature: -10~110°C  
Threaded M/F ISO228/1  
100% leak tested

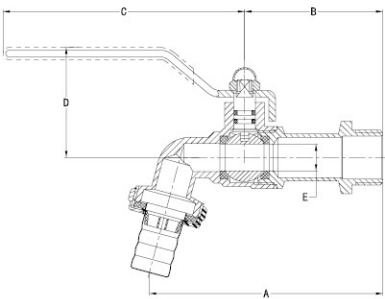

Dimensions

SIZE	A	B	C	D	E
1/2" x1/2"	87	51	90	41	10
3/4" x3/4"	94	56.5	100	45.5	12

Packaging

SIZE	Weight(g)	Inner Box(mm)	Carton(mm)	Qty per inner box	Qty per carton
1/2" x1/2"	185	22x14x8.5	44x23.5x29	12	120
3/4" x3/4"	225	22x14x8.5	44x23.5x29	12	120



BC2039 | Brass Bibcock

Specification

Forged brass body  
Sand blast and nickel plated  
Nominal Pressure: Max. 25bar  
Temperature: -10~110°C  
Threaded M/F ISO228/1  
100% leak tested

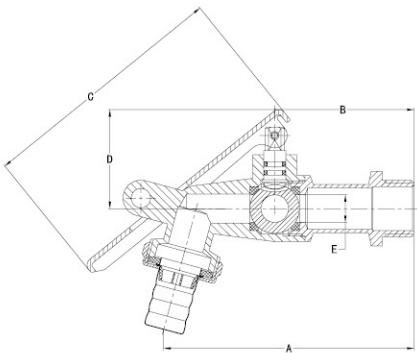

Dimensions

SIZE	A	B	C	D	E
1/2"x3/4"	91.5	50.5	91	29.5	10
3/4"x3/4"	98	58	91	29.5	10

Packaging

SIZE	Weight(g)	Inner Box(mm)	Carton(mm)	Qty per inner box	Qty per carton
1/2"x3/4"	205	22x14x8.5	44.5x23.5x29.5	12	120
3/4"x3/4"	234	22x14x8.5	44.5x23.5x29.5	12	120

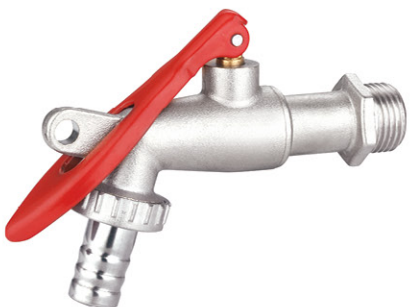



Exhaust Valve

EV1007 | Exhaust Valve

Specification

Forged brass body  
Sand blast and nickel plated  
Nominal Pressure: Max. 25bar  
Temperature: -10~110°C  
Threaded ISO228/1  
100% leak tested

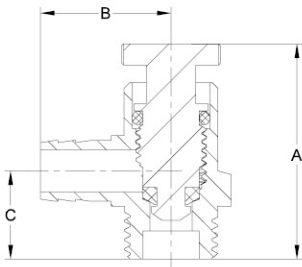

Dimensions

SIZE	A	B	C
1/4"	30	18.5	12.5

Packaging

SIZE	Weight(g)	Inner Box(mm)	Carton(mm)	Qty per inner box	Qty per carton
1/4"	32	29x10x6	31x30x21	12	240



EV1008 | Exhaust Valve

Specification

Forged brass body  
Sand blast and nickel plated  
Nominal Pressure: Max. 25bar  
Temperature: -10~110°C  
Threaded ISO228/1  
100% leak tested

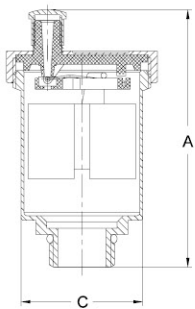

Dimensions

SIZE	A	C
1/2"	82.5	39
3/4"	82.5	39

Packaging

SIZE	Weight(g)	Inner Box(mm)	Carton(mm)	Qty per inner box	Qty per carton
1/2"	140	18.8x10.3x7.8	42.5x23.5x21.3	8	80
3/4"	155	18.8x10.3x7.8	42.5x23.5x21.3	8	80





PF3001 | Equal Straight Union

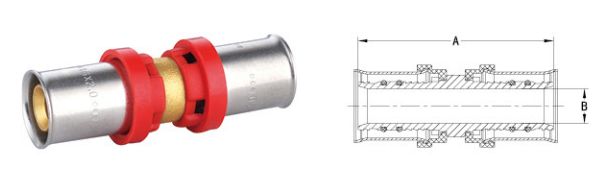

Dimensions and Packaging

SIZE	A	B	Weight(g)	Carton(mm)	Qty per carton
16x16	63	7.5	51	36x25x19.5	210
20x20	63	11.2	72	36x25x19.5	250
26x26	65	14.5	105	36x25x19.5	200
32x32	65	20	147	36x25x19.5	120

PF3002 | Female Straight Union

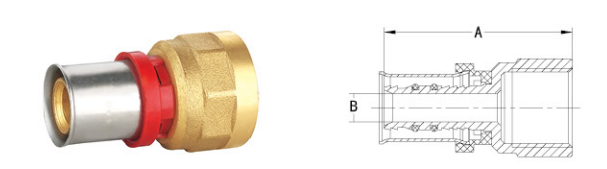

Dimensions and Packaging

SIZE	A	B	Weight(g)	Carton(mm)	Qty per carton
16x1/2"	50	7.5	58	33x23x18	210
16x3/4"	51	7.5	86	33x23x18	200
20x1/2"	50	11.2	69	33x23x18	200
20x3/4"	51	11.2	93	33x23x18	200
26x3/4"	51	14.5	101	33x23x18	200
26x1"	54.5	14.5	133	33x23x18	150
32x1"	54.5	20	150	33x23x18	120
32x1 1/4"	55	20	200	33x23x18	80

PF3005 | Female Elbow

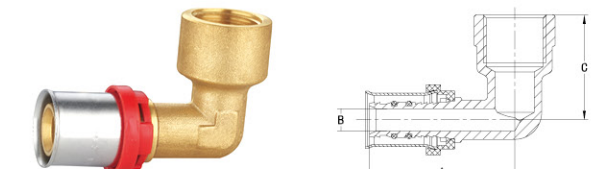

Dimensions and Packaging

SIZE	A	B	C	Weight(g)	Carton(mm)	Qty per carton
16x1/2"	48.5	7.5	35	87	33x23x18	200
16x3/4"	52.5	7.5	40	134	36x25x19.5	180
20x1/2"	52	11.2	35	120	33x23x18	140
20x3/4"	52	11.2	37.3	152	33x23x18	120

PF3006 | Male Elbow

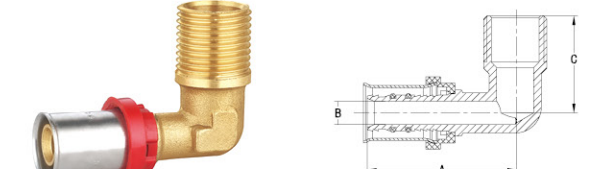

Dimensions and Packaging

SIZE	A	B	C	Weight(g)	Carton(mm)	Qty per carton
16x1/2"	48	7.5	31.5	83	33x23x18	200
16x3/4"	52	7.5	34	97	36x25x19.5	250
20x1/2"	52	11.2	33	102	33x23x18	170
20x3/4"	53	11.2	35.5	115	33x23x18	120

PF3003 | Male Straight Union

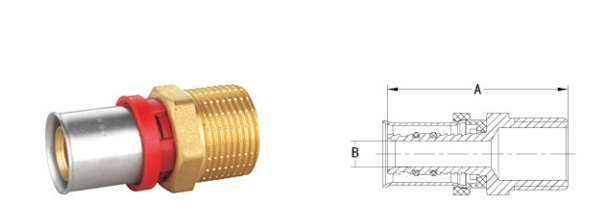

Dimensions and Packaging

SIZE	A	B	Weight(g)	Carton(mm)	Qty per carton
16x1/2"	52	7.5	53	33x23x18	300
16x3/4"	54	7.5	74	33x23x18	250
20x1/2"	52	11.2	61	33x23x18	250
20x3/4"	54	11.2	80	33x23x18	200
26x3/4"	54	14.5	89	33x23x18	160
26x1"	58	14.5	113	33x23x18	120
32x1"	58	20	140	33x23x18	120
32x1 1/4"	58	20	190	33x23x18	80

PF3004 | Equal Elbow

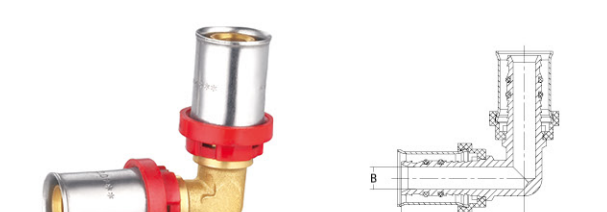

Dimensions and Packaging

SIZE	A	B	Weight(g)	Carton(mm)	Qty per carton
16x16	41.5	7.5	61	33x23x18	200
20x20	43.3	11.2	87	33x23x18	160
26x26	41.5	11.2	144	33x23x18	100
32x32	56	20	250	33x23x18	80

PF3007 | Wall-plated Female Elbow

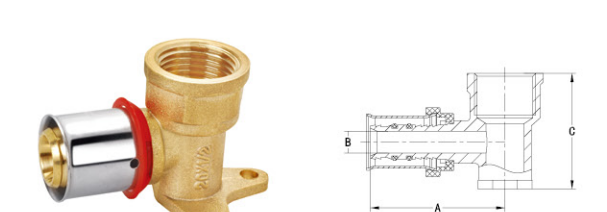

Dimensions and Packaging

SIZE	A	B	C	Weight(g)	Carton(mm)	Qty per carton
16x1/2"	46	7.5	39.5	107	33x23x18	100
20x1/2"	46	11.2	39.5	118	36x25x19.5	100

PF3008 | Reducing Tee

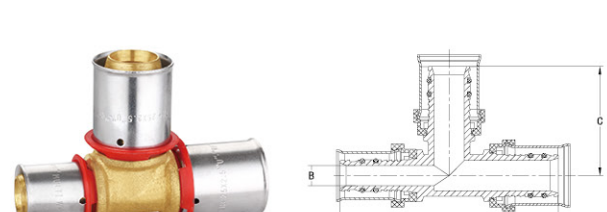

Dimensions and Packaging

SIZE	A	B	C	Weight(g)	Carton(mm)	Qty per carton
16x20x20	81	7.5	40.5	118	33x23x18	100
20x26x26	96	11.2	48	183	36x25x19.5	20



PF3009 | Equal Tee

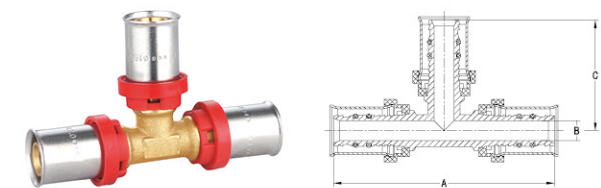

Dimensions and Packaging

SIZE	A	B	C	Weight(g)	Carton(mm)	Qty per carton
16x16x16	83	7.5	41.5	87	33x23x18	100
20x16x20	87	11.2	43.5	120	33x23x18	100
20x20x20	81	11.2	40.5	120	33x23x18	80
20x20x26	97.5	14.5	48.5	183	36x25x19.5	20
26x26x26	96	14.5	48	187	33x23x18	60

PF3010 | Female Tee

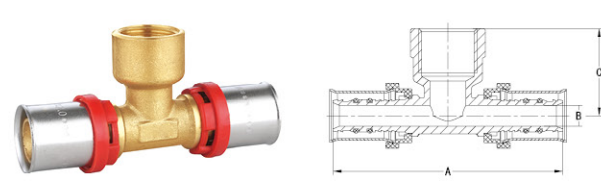

Dimensions and Packaging

SIZE	A	B	C	Weight(g)	Carton(mm)	Qty per carton
16x1/2"x16	83	7.5	31.5	100	33x23x18	120
26x1"x26	113.5	14.5	46	300	36x25x19.5	50
32x1"x32	113.5	20	49.5	416	33x23x18	40

PF4001 | Equal Straight Connector



Dimensions and Packaging

SIZE	A	B	Weight(g)	Carton(mm)	Qty per carton
16x16	52	9.1	102	40.5x24.5x24	200
20x20	57	12.2	135	40.5x24.5x24	200
25x25	63	15.1	213	40.5x24.5x24	160

PF4001 | Reduced Straight Connector

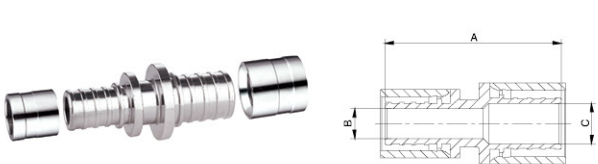

Dimensions and Packaging

SIZE	A	B	Weight(g)	Carton(mm)	Qty per carton
20x16	52	9.1	120	40.5x24.5x24	200
25x16	57	12.2	156	40.5x24.5x24	200
25x20	63	15.1	170	40.5x24.5x24	200

PF3011 | Male Tee

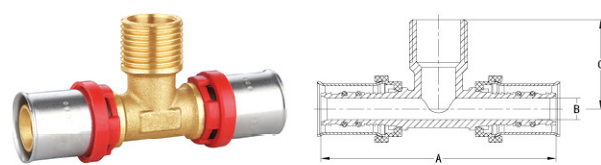

Dimensions and Packaging

SIZE	A	B	C	Weight(g)	Carton(mm)	Qty per carton
16x1/2"x16	83	7.5	31.5	94	33x23x18	120
26x1"x26	113.5	14.5	46	218	36x25x19.5	80
32x1"x32	113.5	20	49.5	337	33x23x18	40

PF4002 | Male Straight Connector



Dimensions and Packaging

SIZE	A	B	Weight(g)	Carton(mm)	Qty per carton
16x1/2"	49	9.1	89	40.5x24.5x24	200
16x3/4"	50.5	9.1	104	40.5x24.5x24	200
16x1"	54	9.1	160	40.5x24.5x24	160
20x1/2"	51.5	12.3	98	40.5x24.5x24	200
20x3/4"	53	12.3	122	40.5x24.5x24	200
20x1"	56.5	12.3	162	40.5x24.5x24	160
25x3/4"	57	15.1	163	40.5x24.5x24	160
25x1"	60	15.1	202	40.5x24.5x24	160

PF4003 | Female Straight Connector



Dimensions and Packaging

SIZE	A	B	Weight(g)	Carton(mm)	Qty per carton
16x1/2"	40.5	9.1	99	40.5x24.5x24	200
16x3/4"	35	9.1	102	40.5x24.5x24	200
20x1/2"	43	12.3	112	40.5x24.5x24	200
20x3/4"	44.5	12.3	119	40.5x24.5x24	200
20x1"	37.5	12.3	153	40.5x24.5x24	200
25x3/4"	45.5	15.1	163	40.5x24.5x24	200
25x1"	47	15.1	203	40.5x24.5x24	160



PF4004 | Equal Elbow

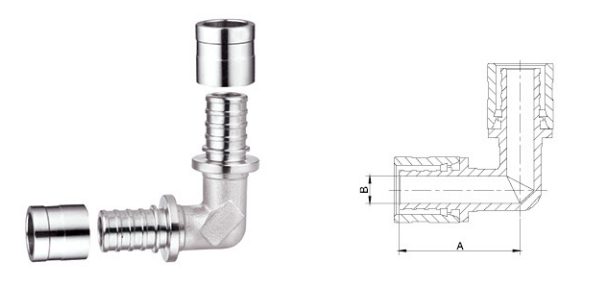

Dimensions and Packaging

SIZE	A	B	Weight(g)	Carton(mm)	Qty per carton
16x16	40	9.1	123	40.5x24.5x24	200
20x20	44	12.3	162	40.5x24.5x24	200
25x25	51.5	15.1	265	40.5x24.5x24	120

PF4004 | Reduced Elbow

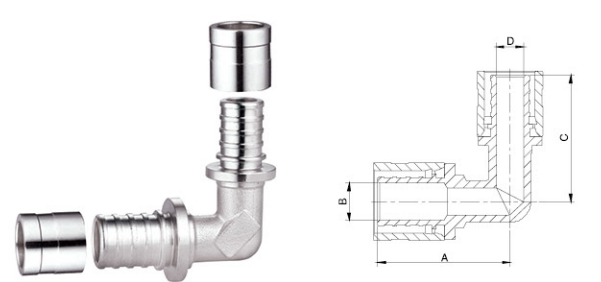

Dimensions and Packaging

SIZE	A	B	C	D	Weight(g)	Carton(mm)	Qty per carton
20x16	43.5	12.3	41.5	9.1	142	40.5x24.5x24	200
25x20	47.5	15.1	48	12.3	198	40.5x24.5x24	160

PF4007 | Male Elbow

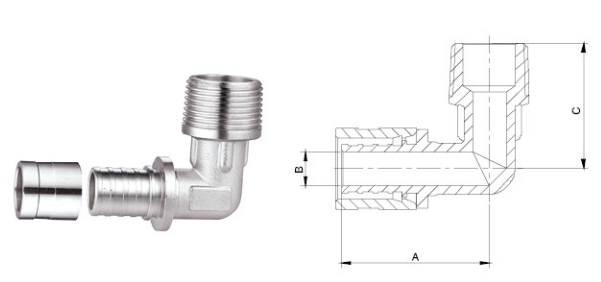

Dimensions and Packaging

SIZE	A	B	C	Weight(g)	Carton(mm)	Qty per carton
16x1/2"	39.3	9.1	33.5	98	40.5x24.5x24	200
20x1/2"	42.7	12.3	35.5	121	40.5x24.5x24	200
20x3/4"	42	12.3	39.5	140	40.5x24.5x24	200
25x3/4"	48.2	15.1	42.5	205	40.5x24.5x24	120

PF4008 | Equal Tee

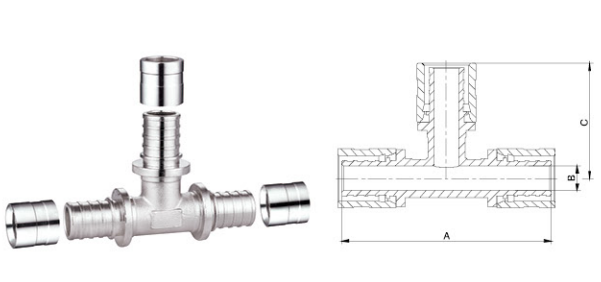

Dimensions and Packaging

SIZE	A	B	C	Weight(g)	Carton(mm)	Qty per carton
16x16x16	76.5	9.1	40.5	175	40.5x24.5x24	140
20x20x20	82.5	12.3	44	238	40.5x24.5x24	120
25x25x25	94.2	15.1	52	372	40.5x24.5x24	80

PF4005 | Female Elbow

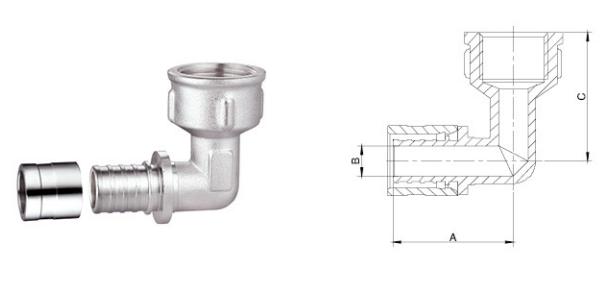

Dimensions and Packaging

SIZE	A	B	C	Weight(g)	Carton(mm)	Qty per carton
16x1/2"	37	9.1	39.3	135	40.5x24.5x24	200
20x1/2"	41.5	12.3	41.3	153	40.5x24.5x24	160
20x3/4"	42	12.3	40	222	40.5x24.5x24	160
25x3/4"	47	15.1	43	222	40.5x24.5x24	120

PF4006 | Wall Plated Female Elbow

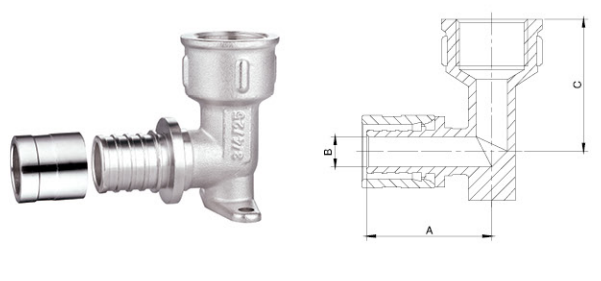

Dimensions and Packaging

SIZE	A	B	C	Weight(g)	Carton(mm)	Qty per carton
16x1/2"	37.5	9.1	40	145	40.5x24.5x24	140
20x1/2"	36.5	9.1	43	168	40.5x24.5x24	120
20x3/4"	43	12.3	43.5	195	40.5x24.5x24	100
25x3/4"	47.8	15.1	44	259	40.5x24.5x24	100

PF4008 | Reducing Tee

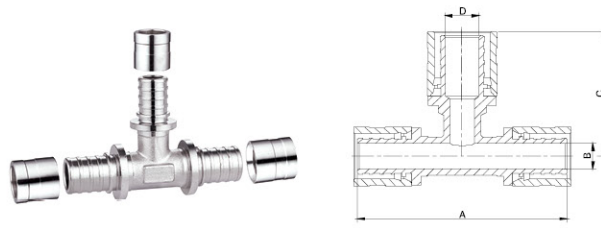

Dimensions and Packaging

SIZE	A	B	C	D	Weight(g)	Carton(mm)	Qty per carton
16x20x16	78	9.1	44	12.3	199	40.5x24.5x24	140
20x16x20	81	12.3	42	9.1	215	40.5x24.5x24	140
20x25x20	89.5	12.3	48	15.1	290	40.5x24.5x24	100
25x16x25	88	15.1	45.5	9.1	298	40.5x24.5x24	100
25x20x25	90.5	15.1	49	12.3	322	40.5x24.5x24	80
20x16x16	77.5	9.1	42	12.3	194	40.5x24.5x24	140
25x16x16	82	9.1	46	15.1	248	40.5x24.5x24	100
25x20x20	86	12.3	48.5	15.1	295	40.5x24.5x24	100
20x20x16	80.5	9.1	45	12.3	212	40.5x24.5x24	140
25x25x16	89.5	9.1	51.5	15.1	346	40.5x24.5x24	100
25x25x20	92.5	12.3	51.5	15.1	367	40.5x24.5x24	80

PF4009 | Equal Female Tee

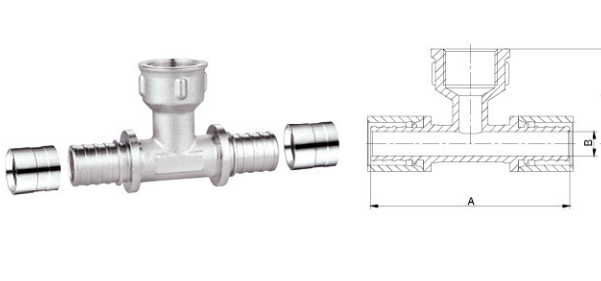

Dimensions and Packaging

SIZE	A	B	C	Weight(g)	Carton(mm)	Qty per carton
16x1/2"x16	74.5	9.1	36.7	161	40.5x24.5x24	140
20x1/2"x20	83	12.3	40.5	193	40.5x24.5x24	120





PF5001 | Equal Straight Union

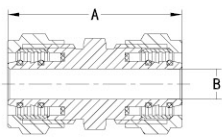

Dimensions and Packaging

SIZE	A	B	Weight(g)	Carton(mm)	Qty per carton
16x16	45	8	102	33x23x15	180
20x20	52	12	185	33x23x15	140
26x26	61.5	15	286	33x23x15	80
32x32	64.5	19.5	544	33x23x15	40

PF5002 | Male Straight Union

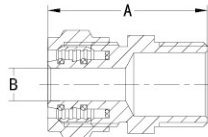
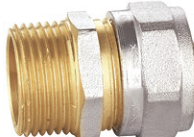

Dimensions and Packaging

SIZE	A	B	Weight(g)	Carton(mm)	Qty per carton
16x1/2"	39	8	67	33x23x15	250
16x3/4"	37.5	8	79	33x23x15	180
20x1/2"	41	12	103	33x23x15	200
20x3/4"	43	12	113	33x23x15	150
26x3/4"	48	15	170	33x23x15	120
26x1"	50	15	174	33x23x15	100
32x1"	54.5	19.5	347	33x23x15	60
32x1 1/4"	56	19.5	369	33x23x15	60

PF5003 | Female Straight Union

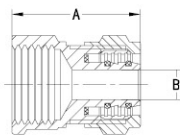

Dimensions and Packaging

SIZE	A	B	Weight(g)	Carton(mm)	Qty per carton
16x1/2"	34.5	8	67	33x23x15	210
16x3/4"	40.5	8	100	33x23x15	150
20x3/4"	40	12	126	33x23x15	150
32x1 1/4"	53.5	19.5	340	33x23x15	60

PF5004 | Elbow

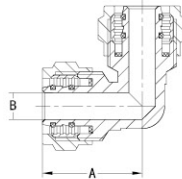

Dimensions and Packaging

SIZE	A	B	Weight(g)	Carton(mm)	Qty per carton
16x16	30	8	104	33x23x15	160
20x20	39	11	203	33x23x15	100
26x26	43	15	265	33x23x15	80
32x32	54	20	610	33x23x15	40



PF5005 | Female Elbow

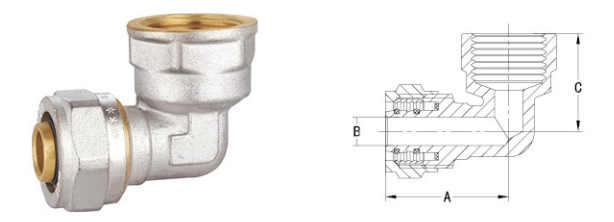

Dimensions and Packaging

SIZE	A	B	C	Weight(g)	Carton(mm)	Qty per carton
16x1/2"	35	8	27.5	96	33x23x15	160
20x3/4"	41	11	31.5	171	33x23x15	120

PF5006 | Equal Tee

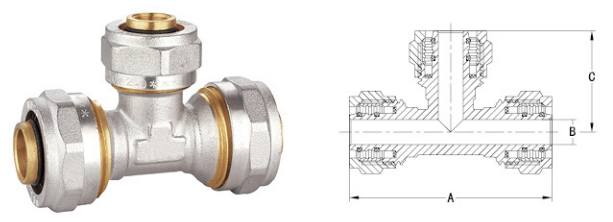

Dimensions and Packaging

SIZE	A	B	C	Weight(g)	Carton(mm)	Qty per carton
16x16x16	65	8	31.5	157	33x23x15	100
20x16x20	75	10.5	37	262	33x23x15	80
20x20x20	75	11	38	285	33x23x15	80

PF5009 | Wall-plated Female Elbow

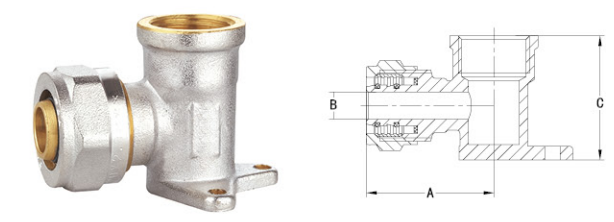

Dimensions and Packaging

SIZE	A	B	C	Weight(g)	Carton(mm)	Qty per carton
16x1/2"	37	8	36.5	121	33x23x15	100

PF5010 | Equal Diameter Four-way

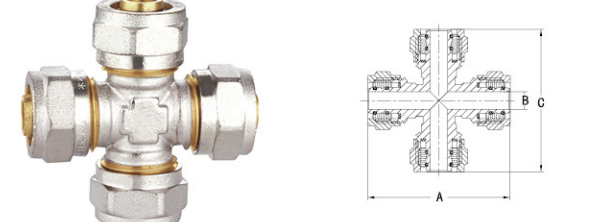

Dimensions and Packaging

SIZE	A	B	C	Weight(g)	Carton(mm)	Qty per carton
16x16x16x16	63	8	63	217	33x23x15	80
20x20x20x20	73	11	73	350	33x23x15	60

PF5007 | Male Tee

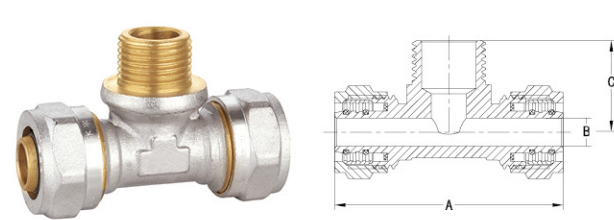

Dimensions and Packaging

SIZE	A	B	C	Weight(g)	Carton(mm)	Qty per carton
16x1/2"x16	65	8	26	132	33x23x15	100
26x1/2"x26	88	14.5	35	304	33x23x15	40

PF5008 | Female Tee

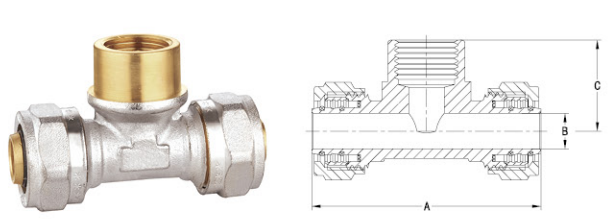

Dimensions and Packaging

SIZE	A	B	C	Weight(g)	Carton(mm)	Qty per carton
16x1/2"x16	80	12	31	140	33x23x15	80
26x1/2"x26	90	14.5	35	312	33x23x15	40



BF4001



Dimensions and Packaging

SIZE	Weight(g)	Carton(mm)	Qty per carton
M22x1.5x1/2"	21	33x23x18	1000
1/2"xM22x1.5	18	33x23x18	1000

BF4002



Dimensions and Packaging

SIZE	Weight(g)	Carton(mm)	Qty per carton
1/2"	22	33x23x18	1000
3/4"	32	33x23x18	600
1"	72	33x23x18	250
1 1/4"	99	33x23x18	200
1 1/2"	125	33x23x18	180

BF4005



Dimensions and Packaging

SIZE	Weight(g)	Carton(mm)	Qty per carton
3/8"x1/2"	28	33x23x18	1000
1/2"x3/4"	38	33x23x18	500
1/2"x1"	77	33x23x18	250
1/2"x1 1/4"	126	33x23x18	160
3/4"x1"	85	33x23x18	250
3/4"x1 1/4"	125	33x23x18	160
1"x1 1/4"	140	33x23x18	160
1"x1 1/2"	163	33x23x18	120
1"x2"	256	33x23x18	100
1 1/4"x2"	265	33x23x18	70

BF4007



Dimensions and Packaging

SIZE	Weight(g)	Carton(mm)	Qty per carton
1 1/4"x1/2"	117	33x23x18	180
1 1/4"x3/4"	120	33x23x18	160
1 1/4"x1"	122	33x23x18	180

BF4003



Dimensions and Packaging

SIZE	Weight(g)	Carton(mm)	Qty per carton
1/2"	22	33x23x18	1000
3/4"	41	33x23x18	600
1"	58	33x23x18	250
1 1/4"	99	33x23x18	200
1 1/2"	125	33x23x18	180

BF4004



Dimensions and Packaging

SIZE	Weight(g)	Carton(mm)	Qty per carton
1/2"	30	33x23x18	700
3/4"	49	33x23x18	360
1"	93	33x23x18	200
1 1/4"	133	33x23x18	130
1 1/2"	174	33x23x18	90
2"	245	33x23x18	50

BF4008



Dimensions and Packaging

SIZE	Weight(g)	Carton(mm)	Qty per carton
10x1/2"M	43	33x23x18	500
10x1/2"F	51	33x23x18	500

BF4009

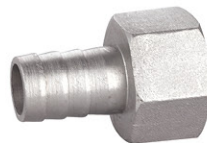

Dimensions and Packaging

SIZE	Weight(g)	Carton(mm)	Qty per carton
1/2"Fx8	34	33x23x18	600
1/2"Fx10	38	33x23x18	600
1/2"Fx12	38	33x23x18	600
1/2"Fx14	36	33x23x18	600
1/2"Fx16	40	33x23x18	500
1/2"Fx18	43	33x23x18	500
1/2"Fx20	51	33x23x18	450
1/2"Fx25	55	36x25x19.5	240
3/4"Fx20	70	33x23x18	250
3/4"Fx25	75	36x25x19.5	238
1"Fx25	115	33x23x18	150



BF4010



Dimensions and Packaging

SIZE	Weight(g)	Carton(mm)	Qty per carton
1/2"Mx8	29	33x23x18	600
1/2"Mx10	31	33x23x18	720
1/2"Mx12	29	33x23x18	720
1/2"Mx14	30	33x23x18	720
1/2"Mx16	29	33x23x18	720
1/2"Mx18	36	33x23x18	500
1/2"Mx20	37	33x23x18	500
1/2"Mx25	51	33x23x18	300
3/4"Mx20	67	33x23x18	360
3/4"Mx25	67	33x23x18	250
1"Mx25	98	33x23x18	200

BF4011



Dimensions and Packaging

SIZE	Weight(g)	Carton(mm)	Qty per carton
1/2"	41	33x23x18	500
3/4"	67	33x23x18	300
1"	123	33x23x18	180
1 1/4"	190	33x23x18	80

BF4014



Dimensions and Packaging

SIZE	Weight(g)	Carton(mm)	Qty per carton
1/2"	85	33x23x18	250
3/4"	140	33x23x18	200
1"	208	33x23x18	150

BF4015



Dimensions and Packaging

SIZE	Weight(g)	Carton(mm)	Qty per carton
1/2"	78	33x23x18	250
3/4"	121	33x23x18	200
1"	210	33x23x18	150

BF4012



Dimensions and Packaging

SIZE	Weight(g)	Carton(mm)	Qty per carton
3/4"x1"	107	33x23x18	140
1"x1 1/4"	178	33x23x18	95

BF4013



Dimensions and Packaging

SIZE	Weight(g)	Carton(mm)	Qty per carton
1/2"	75	33x23x18	250
3/4"	137	33x23x18	200
1"	186	33x23x18	150
1 1/4"	313	33x23x18	100
1 1/2"	418	33x23x18	30

BF4016



Dimensions and Packaging

SIZE	Weight(g)	Carton(mm)	Qty per carton
3/4"x1/2"x3/4"	100	33x23x18	100
1"x1/2"x1"	241	33x23x18	80
1"x3/4"x1"	210	33x23x18	60

BF4017



Dimensions and Packaging

SIZE	Weight(g)	Carton(mm)	Qty per carton
1/2"	95	33x23x18	200
3/4"	158	33x23x18	100
1"	239	33x23x18	60



BF4018



Dimensions and Packaging

SIZE	Weight(g)	Carton(mm)	Qty per carton
1/2"	128	33x23x18	170
3/4"	213	33x23x18	100

BF4019



Dimensions and Packaging

SIZE	Weight(g)	Carton(mm)	Qty per carton
1/2"	92	33x23x18	200
3/4"	110	33x23x18	150

BF4022

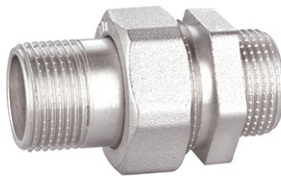

Dimensions and Packaging

SIZE	Weight(g)	Carton(mm)	Qty per carton
1/2"	102	33x23x18	300
3/4"	197	33x23x18	160
1"	294	33x23x18	80

BF4023

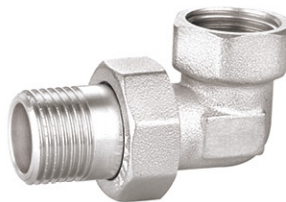

Dimensions and Packaging

SIZE	Weight(g)	Carton(mm)	Qty per carton
1/2"	126	33x23x18	120
3/4"	214	33x23x18	80
1"	322	33x23x18	60

BF4020



Dimensions and Packaging

SIZE	Weight(g)	Carton(mm)	Qty per carton
1/2"	68	33x23x18	200
3/4"	102	33x23x18	160
1"	161	33x23x18	100

BF4021

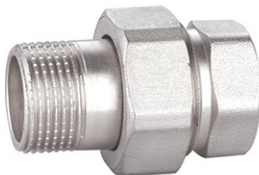

Dimensions and Packaging

SIZE	Weight(g)	Carton(mm)	Qty per carton
1/2"	85	33x23x18	300
3/4"	155	33x23x18	160
1"	255	33x23x18	80
1 1/4"	420	33x23x18	60
1 1/2"	635	33x23x18	40
2"	1160	33x23x18	20

BF4024



Dimensions and Packaging

SIZE	Weight(g)	Carton(mm)	Qty per carton
1/2"	119	33x23x18	140
3/4"	186	33x23x18	75
1"	289	33x23x18	60

BF4025



Dimensions and Packaging

SIZE	Weight(g)	Carton(mm)	Qty per carton
1/2"	9	33x23x18	2100
3/4"	18	33x23x18	1000
1"	26	33x23x18	700
1 1/4"	43	33x23x18	500
1 1/2"	67	33x23x18	250
2"	95	33x23x18	150



Brass Fittings

BF4026



Dimensions and Packaging

SIZE	Weight(g)	Carton(mm)	Qty per carton
1/2"	19	33x23x18	1000
3/4"	21	33x23x18	800
1"	33	33x23x18	500
1 1/4"	48	33x23x18	300
1 1/2"	76	33x23x18	200

BF4028



BF4027



Dimensions and Packaging

SIZE	Weight(g)	Carton(mm)	Qty per carton
1/2"x10	37	33x23x18	500
1/2"x30	58	33x23x18	350
1/2"x50	83	33x23x18	300
1/2"x75	111	33x23x18	200
1/2"x100	138	33x23x18	150
1/2"x150	198	33x23x18	100
1/2"x200	256	25x23x23	100

Dimensions and Packaging

SIZE	Weight(g)	Carton(mm)	Qty per carton
1/2"x10	27	33x23x18	1000
1/2"x15	31	33x23x18	1000
1/2"x20	39	33x23x18	500
1/2"x25	46	33x23x18	500
1/2"x30	49	33x23x18	500
1/2"x40	63	33x23x18	300
1/2"x50	77	33x23x18	280
1/2"x60	87	33x23x18	250
1/2"x70	102	33x23x18	200
1/2"x80	115	33x23x18	200
1/2"x100	145	33x23x18	200
3/4"x10	40	33x23x18	600
3/4"x15	48	33x23x18	600
3/4"x20	57	33x23x18	600
3/4"x25	67	33x23x18	600
3/4"x30	74	33x23x18	600
3/4"x40	95	33x23x18	200
3/4"x50	115	33x23x18	200
3/4"x60	132	33x23x18	200
3/4"x80	162	33x23x18	150
3/4"x100	212	33x23x18	120





IN2001



IN2002



IN2003



IN2004



IN2005



IN2006



IN3001



IN3002



IN3003



IN3004



IN3005



IN3006



IN3007



IN3008



IN3009



IN3010



IN3011



IN3012



IN3013



IN3014



IN3015



IN3016



IN3017



IN3018

